



Service Bulletin

Bulletin No. 2006-24
Jet Drive No. 2006-24

Circulate to: Sales Manager Accounting Service Manager Technician Parts Manager

Mercury Sport Jet 175 Exhaust Cooling

Models Affected

Models Covered	Serial Number Or Year
Sport Jet 175	1997-2002 Powerhead S/N 0E249035 - 0E406250

Situation

If the steering cable has been overheated causing the outer protective sleeve on the steering cable to melt, this melting condition may have been caused by a lack of cooling water being delivered to the exhaust system from the top of the powerhead.

Correction

In the 2003 model year, starting powerhead S/N 0E414101, the fitting at the top of the powerhead which supplies cooling water to the exhaust system was changed to incorporate a strainer, P/N 22-888540. This prevents debris from restricting the cooling water flow to the exhaust system.

The affected units may benefit from the new fitting assembly, P/N 22-888540.

When servicing any Sport Jet 175 in the affected serial number range, visually inspect the fitting for application of a white dot. If no white dot is present, remove and inspect the fitting. If it does not have the strainer feature, it may be replaced with P/N 22-888540.

This fitting assembly, P/N 22-888540, should be used any time the steering cables are replaced.

THE INFORMATION IN THIS DOCUMENT IS CONFIDENTIAL AND PROTECTED BY COPYRIGHT AND IS THE PROPERTY OF MERCURY MARINE.

This document is provided for the sole and exclusive use of the original recipient as prescribed by Mercury Marine and may not be distributed or copied, digitally or otherwise, without the prior written consent of Mercury Marine.

Repair Identification

When the fitting is replaced, the servicing dealer should identify the new fitting with a white paint dot on the top of the fitting.

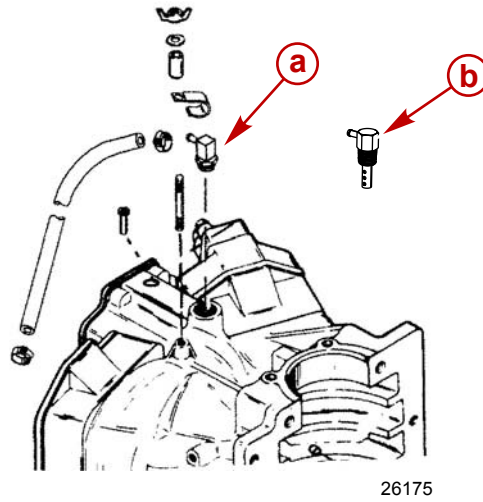

a - Design I

b - Design II

Part Interchangeability

Fitting assembly P/N 22-888540 (Design II) will directly replace the standard fitting P/N 22-814430 (Design I, non-strainer) in the earlier Sport-Jet 175 powerheads.

THE INFORMATION IN THIS DOCUMENT IS CONFIDENTIAL AND PROTECTED BY COPYRIGHT AND IS THE PROPERTY OF MERCURY MARINE.

This document is provided for the sole and exclusive use of the original recipient as prescribed by Mercury Marine and may not be distributed or copied, digitally or otherwise, without the prior written consent of Mercury Marine.