

Circulate to:  Sales Manager  Accounting  Service Manager  Technician  Parts Manager

## Loose Mounting Screws for Carbon Fiber Reeds

### Models Affected

Models Covered	Serial Number
1.5L OptiMax: 115 HP, 115 ProXS, 125 HP	1B976519-2B012682
3.0L OptiMax: 200 OptiMax, 200 ProXS, 225 ProXS, 250 ProXS, 250 OptiMax	

### Scope

Worldwide

### Situation

The screws holding the carbon fiber reeds in place on the reed block may not meet minimum torque requirements causing loose or broken reeds on the air handling assembly (AHA). This results in reduced power and ultimately poor idle quality.

### Dealer Parts Inventory or Dealer Outboard Inventory

#### Dealer Parts in Stock

Any reed block assemblies, part number 840418T04, in dealer stock should be inspected for loose reed mounting screws.

#### OEM or Dealer Outboard Inventory

Any engine in the above serial number range should be checked on MercNET to determine if the engine is affected or has been reworked. Also check the vapor separator for a black paint dot in the middle of the lower bowl half. Any engine that has not been reworked, is in the affected serial number range and is of the affected HP model, must be inspected before delivery to the customer.

THE INFORMATION IN THIS DOCUMENT IS CONFIDENTIAL AND PROTECTED BY COPYRIGHT AND IS THE PROPERTY OF MERCURY MARINE.

This document is provided for the sole and exclusive use of the original recipient as prescribed by Mercury Marine and may not be distributed or copied, digitally or otherwise, without the prior written consent of Mercury Marine.

## Inspection

Remove air plenum or air handling assembly.

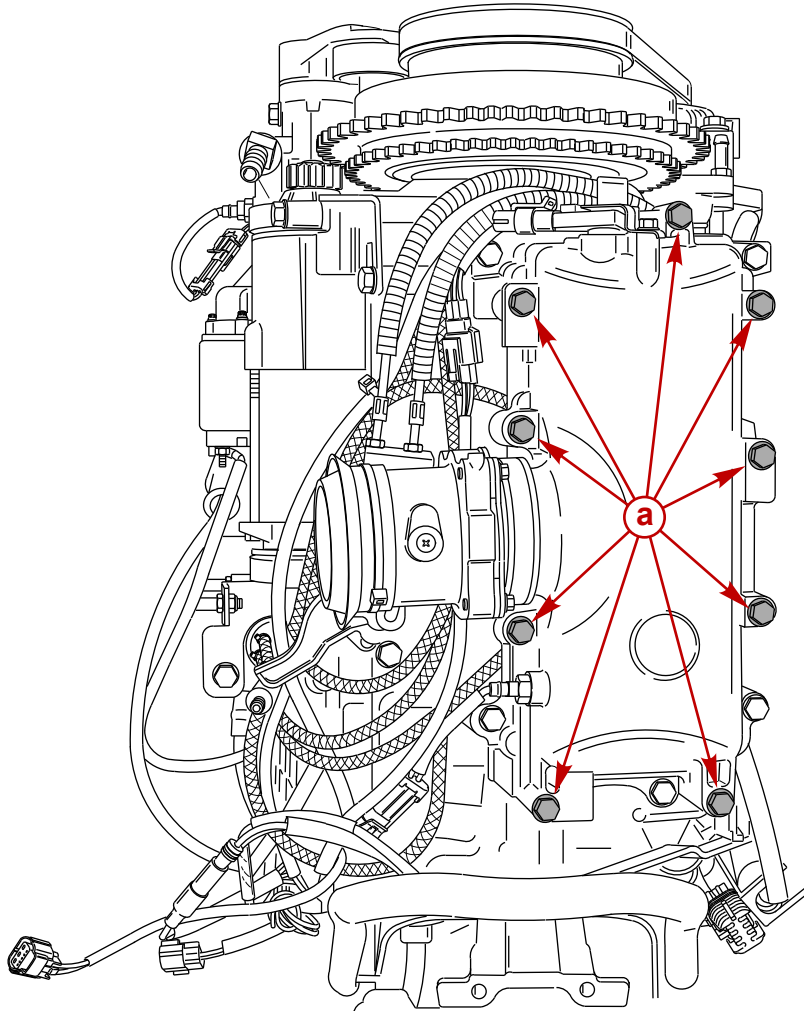

1.5L  
a - Screw (9)

10070

THE INFORMATION IN THIS DOCUMENT IS CONFIDENTIAL AND PROTECTED BY COPYRIGHT AND IS THE PROPERTY OF MERCURY MARINE.

This document is provided for the sole and exclusive use of the original recipient as prescribed by Mercury Marine and may not be distributed or copied, digitally or otherwise, without the prior written consent of Mercury Marine.

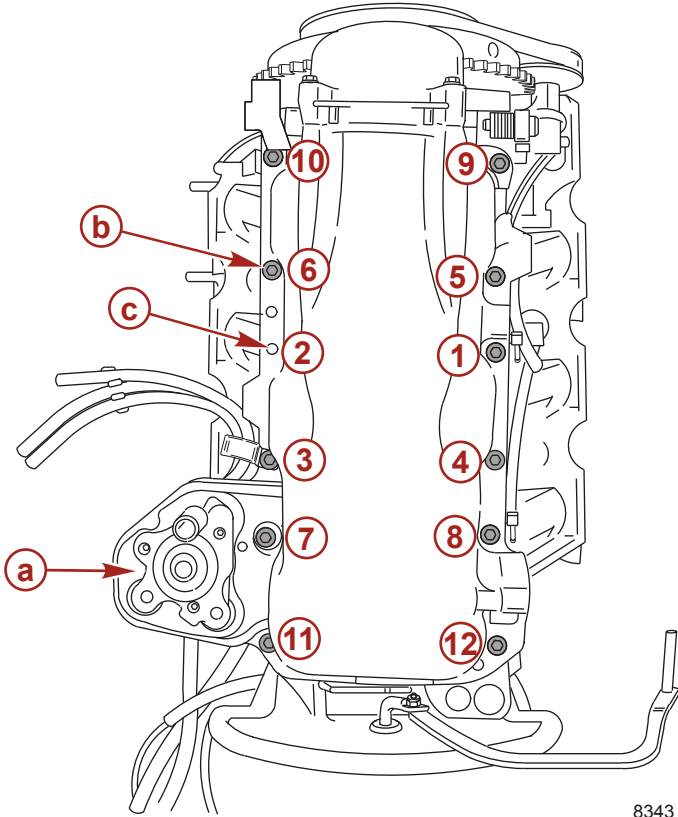

8343

**3.0L**

- a** - Oil pump
- b** - Air plenum mounting screws
- c** - This screw must be removed and installed to secure the air attenuator

**1.5L**

Remove the middle reed block and check the reed mounting screws. After the middle reed block is removed, there should be clearance to check the screws on the remaining two reed block assemblies. If loose screws are found, the reed block may need to be removed to perform the final torque depending on the type of torque wrench.

**3.0L**

Remove the 2, 3, and 5 reed block assemblies and check the reed mounting screws. There should be clearance to check the screws on the remaining three reed block assemblies. If loose screws are found, the reed block may need to be removed to perform the final torque depending on the type of torque wrench.

THE INFORMATION IN THIS DOCUMENT IS CONFIDENTIAL AND PROTECTED BY COPYRIGHT AND IS THE PROPERTY OF MERCURY MARINE.

This document is provided for the sole and exclusive use of the original recipient as prescribed by Mercury Marine and may not be distributed or copied, digitally or otherwise, without the prior written consent of Mercury Marine.

## Loose Mounting Screws for Carbon Fiber Reeds

Inspect all reed screws for proper torque.

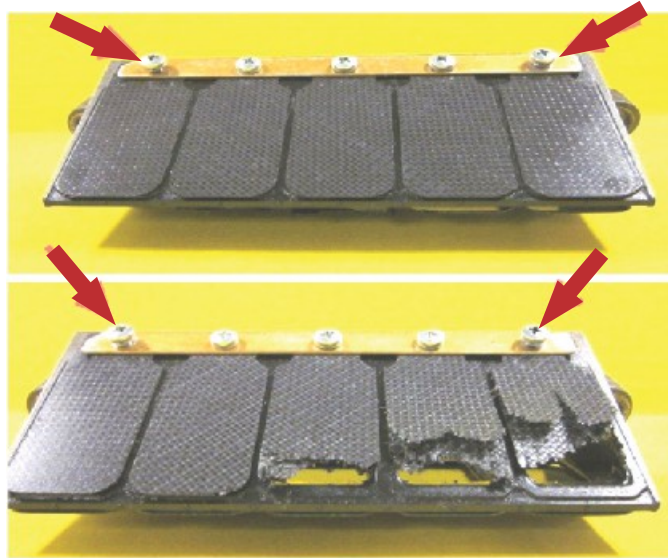

53552

## Correction

Description	Nm	lb-in.	lb-ft
Reed screws	1.1	10	-

If the reed or reed block appears to be damaged, replace with part number 840418T04, carbon fiber reed block assembly. Place a black paint dot on the vapor separator in the location indicated below to indicate the inspection has been completed.

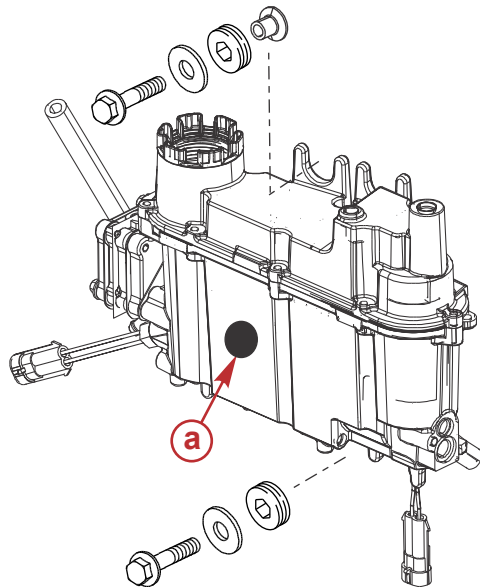

**a** - Black paint dot location

53550

## Owner Notification

A letter will be sent to every registered owner of an affected outboard. The letter instructs the customer to take their engine to any Mercury Outboard authorized dealer for inspection.

A copy of the customer letter is included with this service bulletin for your reference.

## Warranty

Mercury Marine will credit the dealer for the cost of parts and labor.

THE INFORMATION IN THIS DOCUMENT IS CONFIDENTIAL AND PROTECTED BY COPYRIGHT AND IS THE PROPERTY OF MERCURY MARINE.

This document is provided for the sole and exclusive use of the original recipient as prescribed by Mercury Marine and may not be distributed or copied, digitally or otherwise, without the prior written consent of Mercury Marine.

Complete warranty claim listing:

- Outboard serial number
- Quantity and part number

## 1.5L

SB10 and SB08 labor for 1.5L. Includes inspection and post repair confirmation.

- Warranty flat rate code: NJC
- Part code: 748
- Failure code: 00

## 3.0L

SB10 and SB09 labor for 3.0L. Includes inspection and post repair confirmation.

- Warranty flat rate code: NJC
- Part code: 748
- Failure code: 00

**United States and Canada:** Complete and process the claim via MercNET or return a warranty claim form.

**International:** Follow instructions issued by the Marine Power International office or by an authorized Marine Power Distributor.

---

THE INFORMATION IN THIS DOCUMENT IS CONFIDENTIAL AND PROTECTED BY COPYRIGHT AND IS THE PROPERTY OF MERCURY MARINE.

This document is provided for the sole and exclusive use of the original recipient as prescribed by Mercury Marine and may not be distributed or copied, digitally or otherwise, without the prior written consent of Mercury Marine.

Dear Mercury Outboard Owner

Thank you for your purchase of a Mercury Marine product. Mercury Marine is dedicated to providing superior product reliability and customer satisfaction. As part of our commitment to superior customer satisfaction, we have determined that your engine should be returned to any Mercury Marine dealer.

**What is the condition?**

Mercury Marine has determined that the screws holding the induction reeds in place on the reed block may not meet minimum torque requirements causing loose or broken reeds on the air handling assembly. This results in reduced power and ultimately poor idle quality. Mercury Marine has corrected the situation and made the appropriate changes to newly produced product.

**What will Mercury Marine do?**

Mercury Marine has provided instructions to our dealers on the proper method of inspecting and repairing, if necessary, this condition.

**What should you do?**

Make an appointment with your Mercury Marine authorized dealer. Please present this notice and reference Mercury Marine Outboard Service Bulletin 2013-11.

**What if you have other questions or if you no longer own this engine?**

Please contact your Mercury Outboard dealer or call Mercury Outboard Customer Service at 1-920-929-5040 between 7:30 AM and 5:30 PM CST.

We have sent this notice in the interest of your continued satisfaction with our product and we sincerely regret any inconvenience this may cause you.

Thank you for boating with Mercury Marine.  
Mercury Marine Service