

NUMBER: 83-25

- A. Pinion Bearing Now Provided with MerCruiser I Gear Housing Gear Set (43-96084A4)
- B. MerCruiser I 17/28 Gear Housing Gears
- C. Trim Cylinder Inner Tube Guide Now Available

CIRCULATE TO:
SERVICE MANAGER
PARTS MANAGER
MECHANICS
"Place In a Service
Bulletin Binder"

A. PINION BEARING NOW PROVIDED WITH MERCUISER I GEAR HOUSING GEAR SET (43-96084A4)

The 17/28 Gear Housing Gear Sets (43-96084A4), (date coded March 1983 or later) will include Pinion Bearing (31-92366). In the past, it has been necessary to order this bearing separately. This bearing is specially designed to provide additional drive shaft support, which is essential when using the 17/28 gears. BEARING MUST BE INSTALLED WITH THE NUMBERED/LETTERED SIDE TOWARD THE TOP OF THE GEAR HOUSING.

B. MERCUISER I 17/28 GEAR HOUSING GEARS

The 17/28 gear housing gears can now be ordered in the following manner.

Forward and Pinion Gear Set - 43-96084A7
Reverse Gear - 43-92320

The gears are being offered in this fashion to eliminate the need to install a complete gear set in the event of a clutch ramp failure or other minor damage to one of the gears.

The forward and pinion gear are offered as a set only, due to the high loads under which they operate. The reverse gear is not subjected to these high loads and, therefore, is available individually.

IMPORTANT: A gear failure that results from the intermixing of a new gear with damaged used gears will not be covered by Mercury Marine Replacement Parts Limited Warranty.

When mixing new and used gears, the gear(s) that are to be reused MUST BE carefully inspected to ensure that they are in good condition. Mercury Marine specifically does not recommend individual replacement of gears if a gear tooth failure has occurred, as secondary damage to the teeth on the other gears often occurs in this type of a failure. This type of damage is often difficult to detect with the naked eye. Gear Set (43-96084A2 or A4) should be used in these cases.

C. TRIM CYLINDER INNER TUBE GUIDE NOW AVAILABLE

The inner tube guide (Figure 1) for the internal return type trim cylinders are now available under the following part numbers:

MerCruiser I Models - 45521
TR and TRS Models - 47344

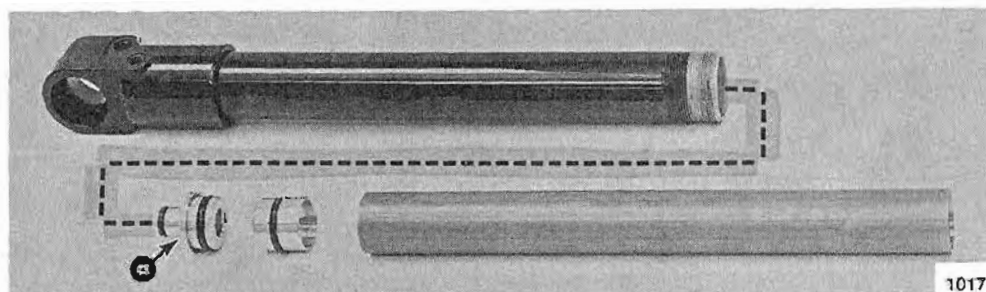

a - Inner Tube Guide

Figure 1. Inner Tube Guide (Typical Trim Cylinder)