



# Service Bulletin

Bulletin No. 2009-64  
CMD 2009-04

Circulate to:  Sales Manager  Accounting  Service Manager  Technician  Parts Manager

## Zeus 3000 Series Pod Drive Model Changes

### Models Affected

Model	Serial Number Range
Zeus 3000 Series Pod Drive	0M963371 and above

### Situation

Cummins MerCruiser Diesel (CMD) has made several changes to production Zeus IH drives that correspond to a model identification change from the IH model to the Zeus 3000 Series Pod Drive model. This model has enhanced product durability and is easier to service.

The publication of updated service manual information for the Zeus 3000 Series Pod Drive model is scheduled for July 2009.

The Zeus 3000 Series Pod Drive model changes include:

- **More convenient location for serial numbers**

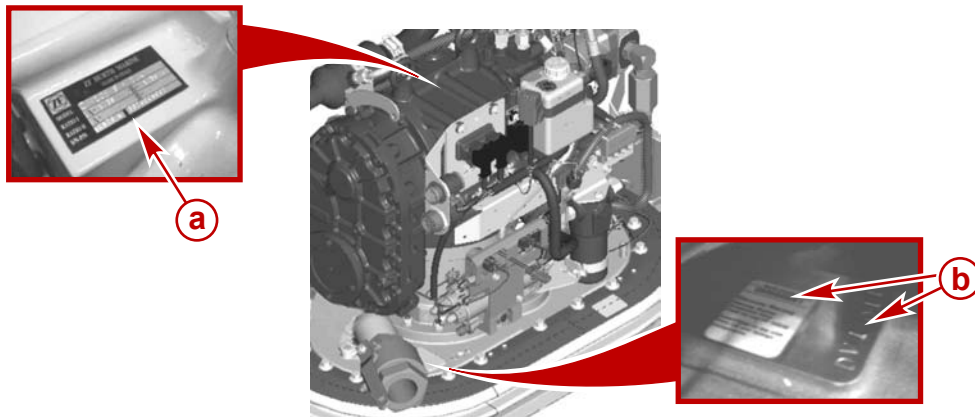

- a** - Transmission serial number plate
- b** - Drive serial number decal and stamping

THE INFORMATION IN THIS DOCUMENT IS CONFIDENTIAL AND PROTECTED BY COPYRIGHT AND IS THE PROPERTY OF MERCURY MARINE.

This document is provided for the sole and exclusive use of the original recipient as prescribed by Mercury Marine and may not be distributed or copied, digitally or otherwise, without the prior written consent of Mercury Marine.

- Removal of the steering backup pump system

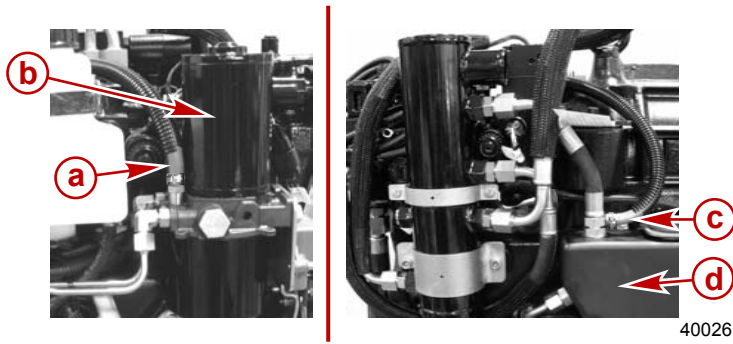

IH model

**a** - Return hose (port side connection)

**b** - Steering backup pump

**c** - Return hose (starboard connection)

**d** - Hydraulic oil reservoir



41313

3000 Series model without steering backup pump

- Improvement of trim tab anode plate design

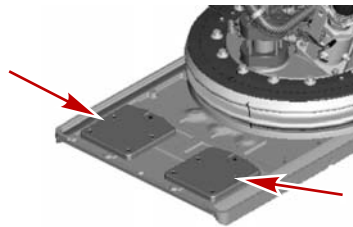

41251

Dual anode design

THE INFORMATION IN THIS DOCUMENT IS CONFIDENTIAL AND PROTECTED BY COPYRIGHT AND IS THE PROPERTY OF MERCURY MARINE.

This document is provided for the sole and exclusive use of the original recipient as prescribed by Mercury Marine and may not be distributed or copied, digitally or otherwise, without the prior written consent of Mercury Marine.

- Redesigned center section with seacock improvements

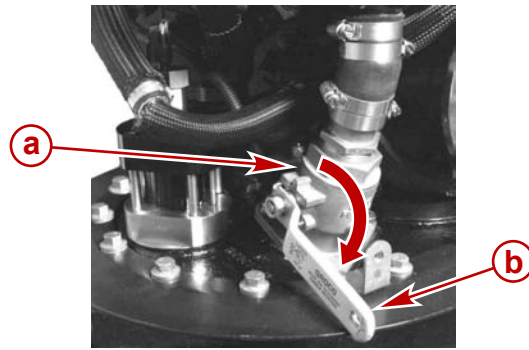

41199

**Easier access to seawater return seacock**

- a** - Seacock
- b** - Handle

**NOTE:** The 3000 Series Pod Drive is shipped with a cover plate (not shown) over the seawater inlet opening. The installer can leave the cover installed when using an alternate seawater pickup location or remove the cover and orient the included seawater inlet seacock to port or starboard.

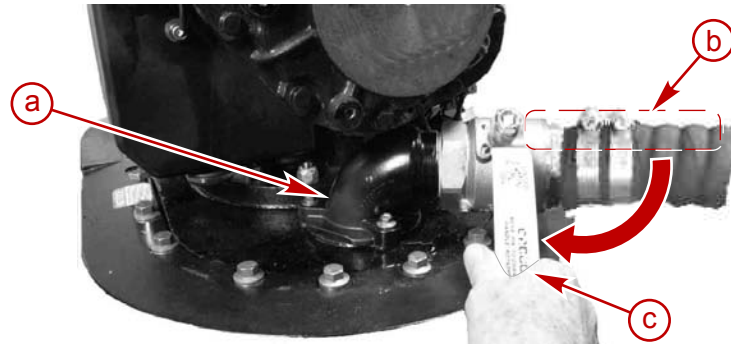

41196

**Port orientation shown, starboard similar**

- a** - Seacock
- b** - Open position
- c** - Handle in closed position

THE INFORMATION IN THIS DOCUMENT IS CONFIDENTIAL AND PROTECTED BY COPYRIGHT AND IS THE PROPERTY OF MERCURY MARINE.

This document is provided for the sole and exclusive use of the original recipient as prescribed by Mercury Marine and may not be distributed or copied, digitally or otherwise, without the prior written consent of Mercury Marine.

- Redesigned optional drive cover with cut-outs for gear lube and steering manifold access

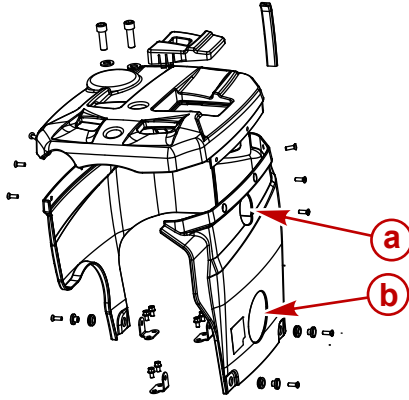

41312

- a - Gear lube level
- b - Steering and trim manifold access

- Manual override for steering and trim

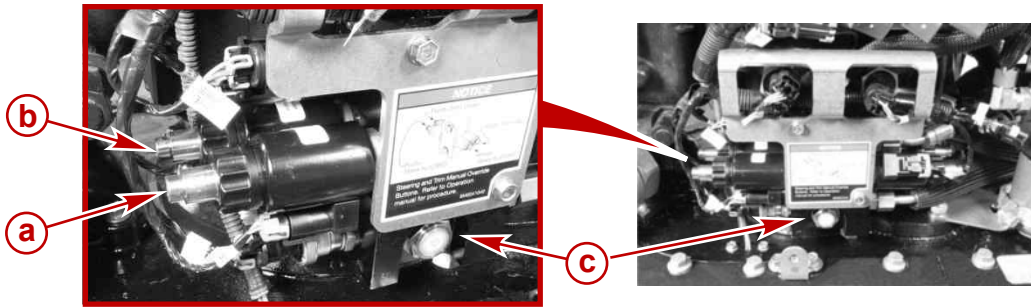

41307

- a - Steer-to-starboard control valve
- b - Trim-down control valve
- c - Manifold

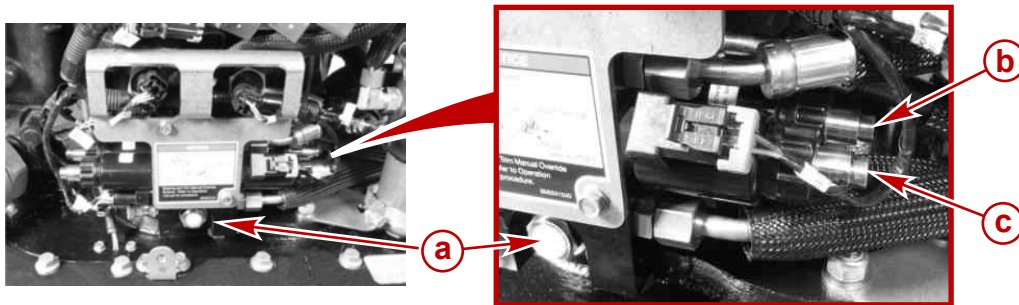

41309

- a - Manifold
- b - Trim-up control valve
- c - Steer-to-port control valve

THE INFORMATION IN THIS DOCUMENT IS CONFIDENTIAL AND PROTECTED BY COPYRIGHT AND IS THE PROPERTY OF MERCURY MARINE.

This document is provided for the sole and exclusive use of the original recipient as prescribed by Mercury Marine and may not be distributed or copied, digitally or otherwise, without the prior written consent of Mercury Marine.

- Relocation of the trim hydraulic control valves to the steering manifold

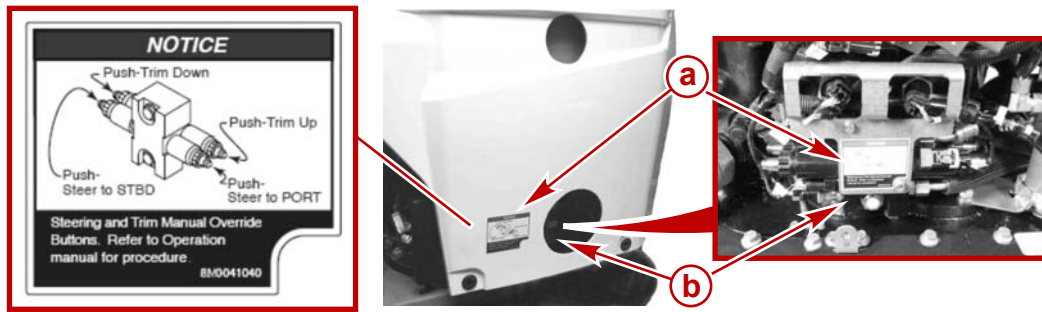

41303

**Steering and trim manifold with manual override buttons**

- a** - Information decal
- b** - Steering and trim manifold

- **Enhanced gear housing mounting**

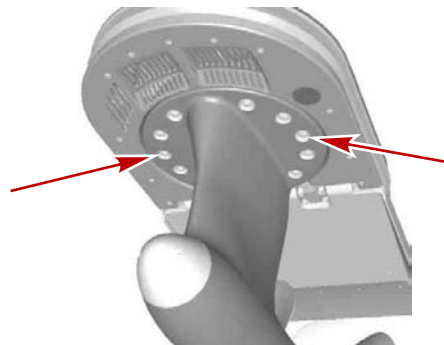

41314

**Two additional fasteners**

- **An in-line magnetic oil filter**

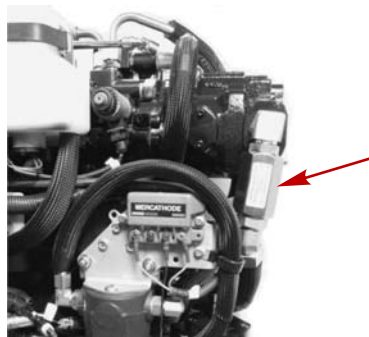

41488

**In-line magnetic oil filter**

THE INFORMATION IN THIS DOCUMENT IS CONFIDENTIAL AND PROTECTED BY COPYRIGHT AND IS THE PROPERTY OF MERCURY MARINE.

This document is provided for the sole and exclusive use of the original recipient as prescribed by Mercury Marine and may not be distributed or copied, digitally or otherwise, without the prior written consent of Mercury Marine.

- A sensor on the high-pressure oil filter to monitor oil flow

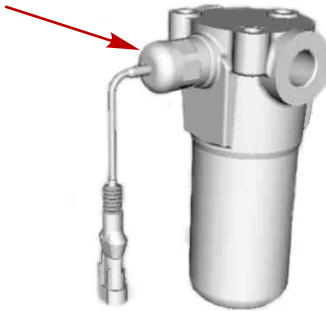

41489

Sensor to monitor oil flow

- Removal of the exhaust temperature sensor from the exhaust cavity of the steering actuator

*NOTE: The hole in the exhaust cavity is plugged and a cap will seal the temperature sensor connector remaining on the harness. The sensor can now be located according to the engine manufacturer.*

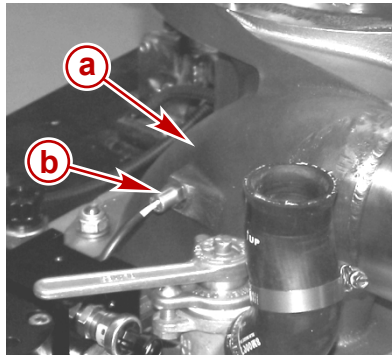

34561

Previous location on steering actuator

- a - Exhaust cavity
- b - Exhaust temperature sensor

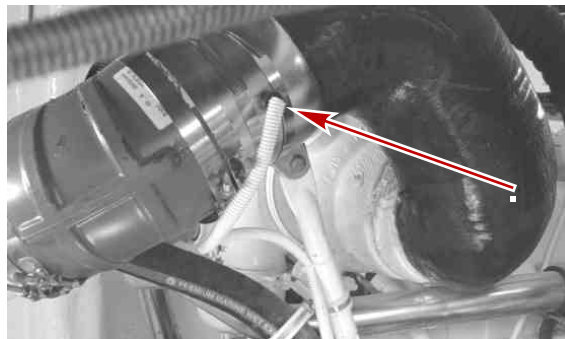

41490

Example of a location near the exhaust elbow

THE INFORMATION IN THIS DOCUMENT IS CONFIDENTIAL AND PROTECTED BY COPYRIGHT AND IS THE PROPERTY OF MERCURY MARINE.

This document is provided for the sole and exclusive use of the original recipient as prescribed by Mercury Marine and may not be distributed or copied, digitally or otherwise, without the prior written consent of Mercury Marine.