



Service Bulletin

Bulletin No. 2010-63
CMD 2010-03

Circulate to: Sales Manager Accounting Service Manager Technician Parts Manager

CMD Bravo Sterndrive Fill Procedure and Lube Level Drop During Break-In Period

Models Affected

All Bravo Sterndrives

Situation

Cummins MerCruiser Diesel has received reports of a drop in the level of gear lube after the sterndrive is first put into service. Air trapped in the top of the driveshaft housing during the initial filling of the sterndrive may escape through the gear lube monitor during the break-in period (first 20 hours of running time). As the trapped air escapes, the gear lube level in the monitor bottle drops.

New installations may require as much as 470 mL (16 fl oz) of gear lube added to the monitor bottle during the break-in period (20 hours of running time). It is important to monitor and maintain the gear lube level during the break-in period. If fluid is still required after the break-in period, refer to **CMD Service Bulletin 2010-04**.

Action

Check the gear lube monitor at the beginning of each day when the engine is cold. Fill as needed. If the gear lube alarm sounds during operation, add the appropriate amount of gear lube to the monitor bottle.

Tube Ref No.	Description	Where Used	Part No.
 87	High Performance Gear Lube	Gear lube monitor	92-858064K01

NOTICE

Discharge of oil, coolant, or other engine/drive fluids into the environment is restricted by law. Use caution not to spill oil, coolant, or other fluids into the environment when using or servicing your boat. Be aware of the local restrictions governing the disposal or recycling of waste, and contain and dispose of fluids as required.

Checking

IMPORTANT: The gear lube level fluctuates during operation. Check before starting, when the engine is cold.

1. Check the gear lube level in the monitor bottle. Maintain the gear lube level within the recommended operating range. Refer to **Filling**.

THE INFORMATION IN THIS DOCUMENT IS CONFIDENTIAL AND PROTECTED BY COPYRIGHT AND IS THE PROPERTY OF MERCURY MARINE.

This document is provided for the sole and exclusive use of the original recipient as prescribed by Mercury Marine and may not be distributed or copied, digitally or otherwise, without the prior written consent of Mercury Marine.

- Inspect the gear lube condition. If any water is visible in the bottom of the gear lube monitor, if water appears at the fill and drain plug hole, or if the gear lube appears discolored, these conditions can indicate a water leak in the sterndrive.

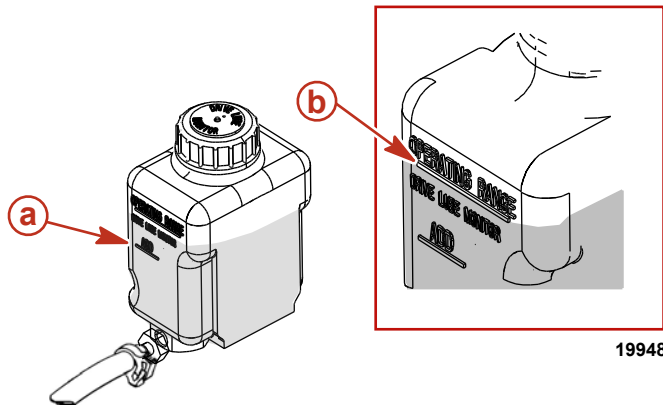

Gear lube level shown in the correct operating range
a - "ADD" mark
b - "OPERATING RANGE" mark

19948

IMPORTANT: If water is visible in the bottom of the gear lube monitor or appears at the fill and drain plug hole, or if the gear lube appears discolored, the sterndrive may be leaking.

Filling

IMPORTANT: The addition of more than 470 mL (16 fl oz) of gear lube during the break-in period may indicate that the sterndrive is leaking.

- Remove the gear lube monitor cap.

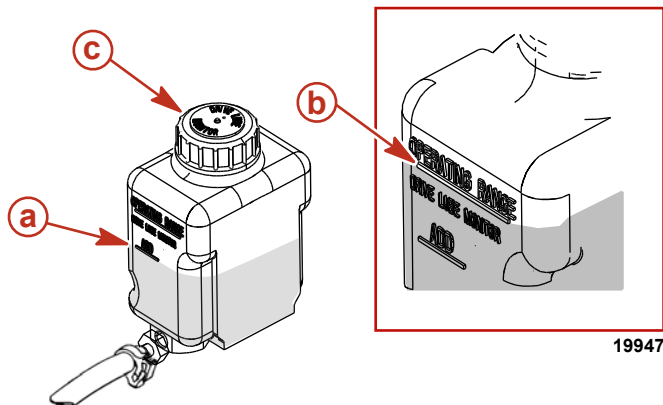

a - Gear lube level at the "ADD" mark
b - Gear lube level at the "OPERATING RANGE" mark
c - Gear lube monitor cap

19947

- Fill the monitor with the specified fluid until the gear lube level is in the operating range. Do not overfill.

Tube Ref No.	Description	Where Used	Part No.
 87	High Performance Gear Lube	Gear lube monitor	92-858064K01

- Ensure that the rubber gasket is inside the gear lube monitor cap.
- Clean and install the cap. Do not overtighten.

Warranty

This service bulletin is informational only.

THE INFORMATION IN THIS DOCUMENT IS CONFIDENTIAL AND PROTECTED BY COPYRIGHT AND IS THE PROPERTY OF MERCURY MARINE.

This document is provided for the sole and exclusive use of the original recipient as prescribed by Mercury Marine and may not be distributed or copied, digitally or otherwise, without the prior written consent of Mercury Marine.