

Circulate to: Sales Manager Accounting Service Manager Technician Parts Manager

Mercury Racing X-Haust Assemblies

Models Affected

Models Covered	Serial Number or Year
X-Haust assemblies	Sold before August 24, 2015

Scope

Worldwide

Situation

Axisus/Joystick model boats with a transom that is more than 2 in. thick, and are using the X-Haust kit, may have the lower exhaust pipe contacting the steering actuator. This situation could affect the steering ability of the watercraft. All watercraft using the X-Haust assembly should be inspected and repaired if contact is observed.

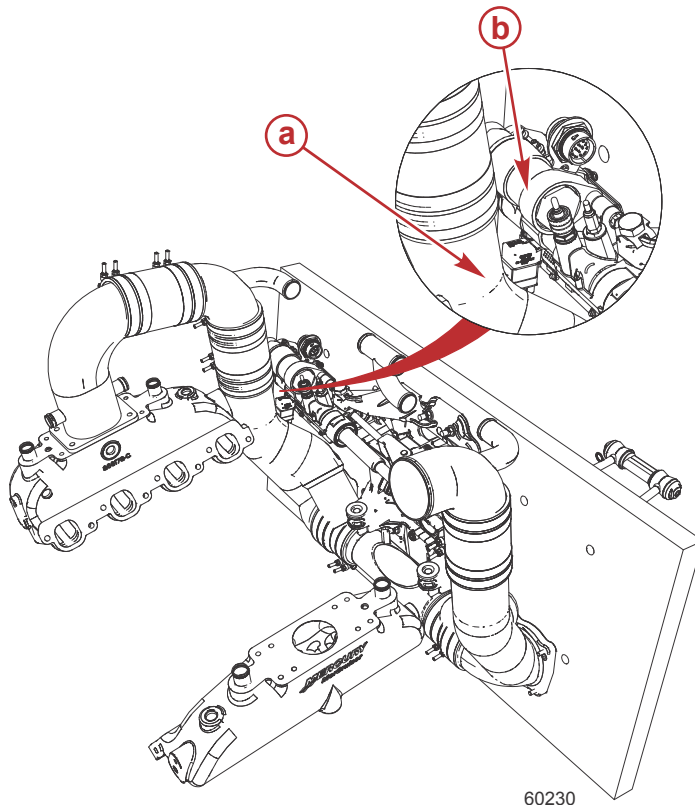

- a - Lower exhaust pipe
- b - Steering actuator

THE INFORMATION IN THIS DOCUMENT IS CONFIDENTIAL AND PROTECTED BY COPYRIGHT AND IS THE PROPERTY OF MERCURY MARINE.

This document is provided for the sole and exclusive use of the original recipient as prescribed by Mercury Marine and may not be distributed or copied, digitally or otherwise, without the prior written consent of Mercury Marine.

Correction

Turn the drive full port and full starboard while observing the clearance between the steering actuator and the lower exhaust tube on the starboard side of the engine. Replace the lower exhaust tube on the starboard side of the engine if contact is made (only the lower pipe on the starboard side of the engine will be required).

Shift Cable

Take care when routing the shift cable from the drive to the engine. Be sure to route the cable away from sharp objects, rotating parts or assemblies, and hot exhaust components. Route the cable in order to achieve wide arcs and avoid sharp bends. Make sure that the cable moves freely when shifting. Do not pinch the cable between parts, and observe the cable as it shifts through the gears to make sure that the cable moves freely.

Required Parts

Qty.	Description	Part Number
1	Starboard engine kit, starboard outlet	8M0111184
1	Port engine kit, starboard outlet	8M0111183
1	4200 sealant	Obtain locally

Warranty

Mercury Marine will credit the dealer for the parts and labor. Complete a warranty claim listing:

- Sterndrive engine serial number
- Indicate parts and accessories (P & A) claim
- Part number used for each engine

Warranty Time and Codes

- Labor: 6.0 hours (R/R of the engine)
- Labor: 1.0 hour (exhaust pipe replacement)
- Warranty flat rate code: SB6.0
- Warranty flat rate code: SB1.0
- Part code: 506
- Failure code: 00

U.S. and Canada

Complete and process the claim via MercNET or return a warranty claim form.

International

Follow the instructions issued by the Marine Power international office or by an authorized Marine Power distributor.

THE INFORMATION IN THIS DOCUMENT IS CONFIDENTIAL AND PROTECTED BY COPYRIGHT AND IS THE PROPERTY OF MERCURY MARINE.

This document is provided for the sole and exclusive use of the original recipient as prescribed by Mercury Marine and may not be distributed or copied, digitally or otherwise, without the prior written consent of Mercury Marine.