



PARTS CATALOG

200 ENGINE

SERIAL NUMBER

200 GM 292 I/L6 1969 2453769 THRU 2712072

TABLE OF CONTENTS:

CARBURETOR ASSEMBLY, COMPLETE	16
CYLINDER BLOCK, PISTON AND CRANKSHAFT	30
CYLINDER HEAD AND OIL PAN	34
DISTRIBUTOR ASSEMBLY AND COIL	6
ENGINE MOUNTING	26
EXHAUST KIT	38
EXHAUST MANIFOLD AND EXHAUST ELBOW	20
FLYWHEEL HOUSING	24
FUEL PUMP, CARBURETOR AND THROTTLE LINKAGE	10
PARTS INDEX	40
STARTER MOTOR AND ALTERNATOR	4
WATER PUMP ASSEMBLY, COMPLETE	28
WIRING HARNESS, VOLTAGE REGULATOR AND STARTER SOLENOID	2

NOTE: *Indented description indicate that these parts are included in preceeding assembly.*

AR = As Required

NSS = Not Sold Separate

OPT = Optional

NS = Not Shown

THESE PARTS BOOKS/FICHE CARD ARE COPYRIGHTED AND MAY NOT BE DISTRIBUTED OR REPRODUCED IN ANY OTHER FORMAT BY ANYONE OTHER THAN MERCURY MARINE WITHOUT THE PRIOR WRITTEN CONSENT OF MERCURY MARINE.

REPLACEMENT PARTS ! WARNING !

Electrical, ignition and fuel system components on MerCruiser Engines and Stern Drives are designed and manufactured to comply with U.S. Coast Guard Rules and Regulations to minimize risks of fire or explosion. Use of replacement electrical, ignition or fuel system components, which do not comply to these rules and regulations, could result in a fire or explosion hazard and should be voided.

When servicing the electrical, ignition and fuel systems, it is extremely important that all components are properly installed and tightened. If not, any electrical or ignition component opening would permit sparks to ignite fuel vapors from fuel system leaks, if they existed.

ENGINE MECHANICAL COMPONENTS

Many of the engine mechanical components are designed for marine applications. Unlike automotive engines, marine engines are subjected to extended periods of heavy load and wide- open-throttle operation, therefore, require heavy-duty components. Special marine engine parts have design and manufacturing specifications, which are required to provide long life and dependable performance. Marine engine parts also must be able to resist the corrosive action of salt or brackish water that will rust or corrode standard automotive parts within a short period of time.

Failure to use recommended Mercury Precision Parts OR Quicksilver service replacement parts can result in poor engine performance and/or durability, rapid corrosion of parts subjected to salt water and possibly complete failure of the engine.

Use of parts other than recommended service replacement parts will void the warranty on those parts which are damaged as a result of the use of other than recommended parts.

WIRING HARNESS, VOLTAGE REGULATOR AND STARTER SOLENOID

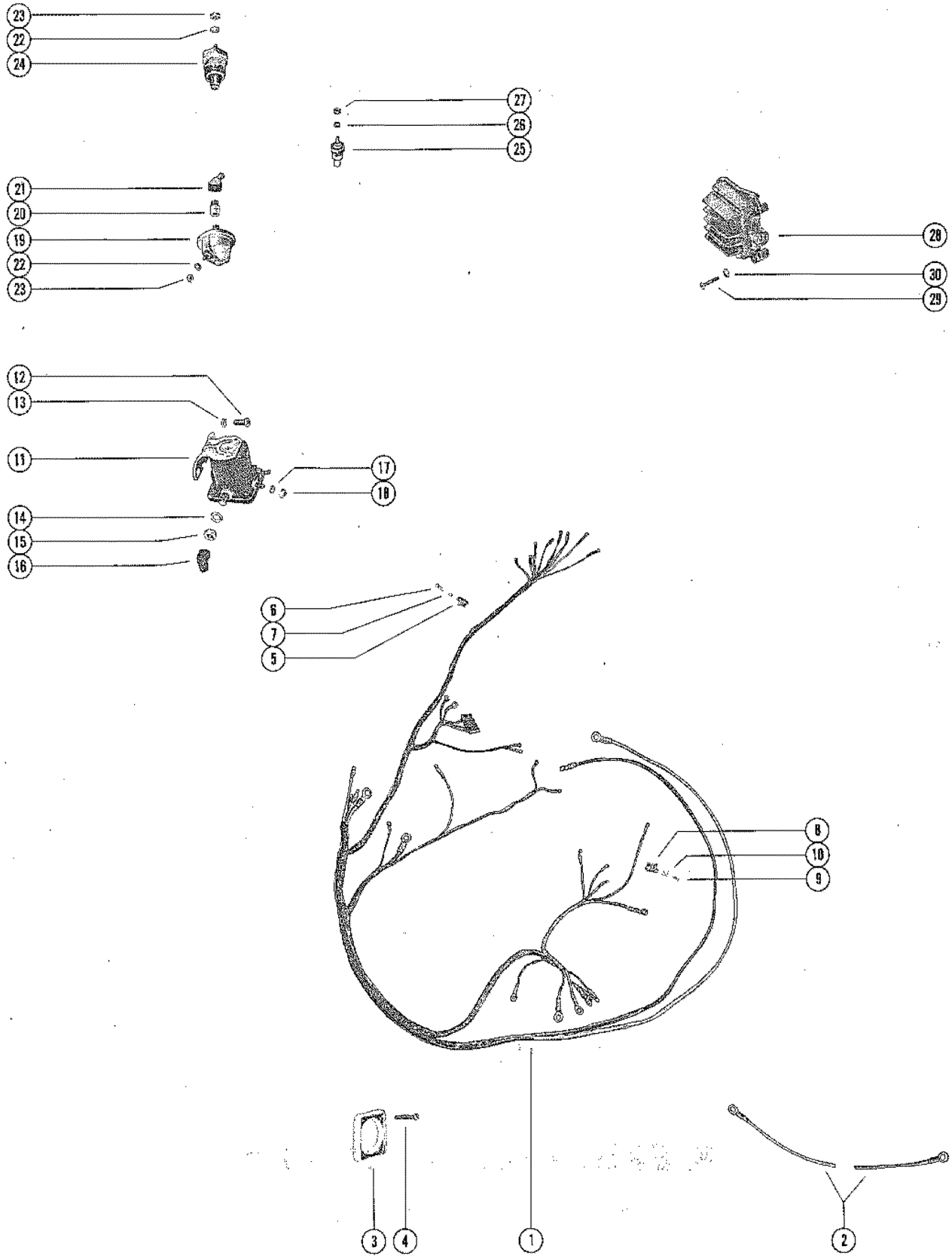

WIRING HARNESS, VOLTAGE REGULATOR AND STARTER SOLENOID

REF. NO.	PART NO.	SYM.	QTY.	DESCRIPTION
1	52636		1	WIRING HARNESS, EXTERNAL
2	45108		1	BATTERY CABLE, POSITIVE LUG TYPE
	45107		1	BATTERY CABLE, NEGATIVE LUG TYPE
3	26079		1	PLATE, WIRING HARNESS TO MOUNTING BRACKET
4	10-46718		4	SCREW, WIRING HARNESS PLATE TO MOUNTING BRACKET (3/4")
5	54-22627		2	CLIP, WIRING HARNESS TO BOAT
6	10-22793		2	SCREW, WOOD - WIRING HARNESS CLIP TO BOAT (7/8"0
7	22789		2	"D" WASHER, WIRING HARNESS CLIP SCREW
8	54-24836		1	CLAMP, WIRING HARNESS TO MANIFOLD
9	10-30268		1	SCREW, CLAMP TO MANIFOLD
10	22789		1	"D" WASHER, WIRING HARNESS CLIP SCREW
11	25661		1	STARTER SOLENOID
12	10-28063		2	SCREW, STARTER SOLENOID TO FLYWHEEL HOUSING (5/8")
13	13-26992		2	LOCKWASHER, STARTER SOLENOID SCREW
14	13-26993		2	LOCKWASHER, STARTER SOLENOID TERMINAL (5/16")
15	11-20083		2	NUT, STARTER SOLENOID TERMINAL (5/16")
16	46265		1	BOOT, SOLENOID TERMINAL
17	13-26996		2	LOCKWASHER, STARTER SOLENOID TERMINAL (#10)
18	11-20645		2	NUT, STARTER SOLENOID TERMINAL (10-32)
19	34623		1	OIL PRESSURE SENDER ASSEMBLY
20	22-32974		1	ADAPTOR, OIL PRESSURE SENDER TO CYLINDER BLOCK
21	22-29085		1	FITTING, OIL PRESSURE SENDER ADAPTOR SERIAL 02494936-09999999
22	13-26996		2	WASHER, WATER SENDER/OIL PRESSURE SENDER TERMINAL (#10)
23	11-20645		2	NUT, WATER SENDER/OIL PRESSURE SENDER TERMINAL (10-32)
24	36525		1	WATER TEMPERATURE SENDER ASSEMBLY
25	52676		1	SWITCH, THERMAL - CHOKE
26	13-26996		1	LOCKWASHER, THERMAL SWITCH TERMINAL
27	11-20645		1	NUT, THERMAL SWITCH TERMINAL
28	37707		1	VOLTAGE REGUALTOR, TRANSISTORIZED
29	10-37908		3	SCREW, VOLTAGE REGULATOR TO TRANSOM (1 1/4")
30	12-20028		3	WASHER, VOLTAGE REGULATOR SCREW

STARTER MOTOR AND ALTERNATOR

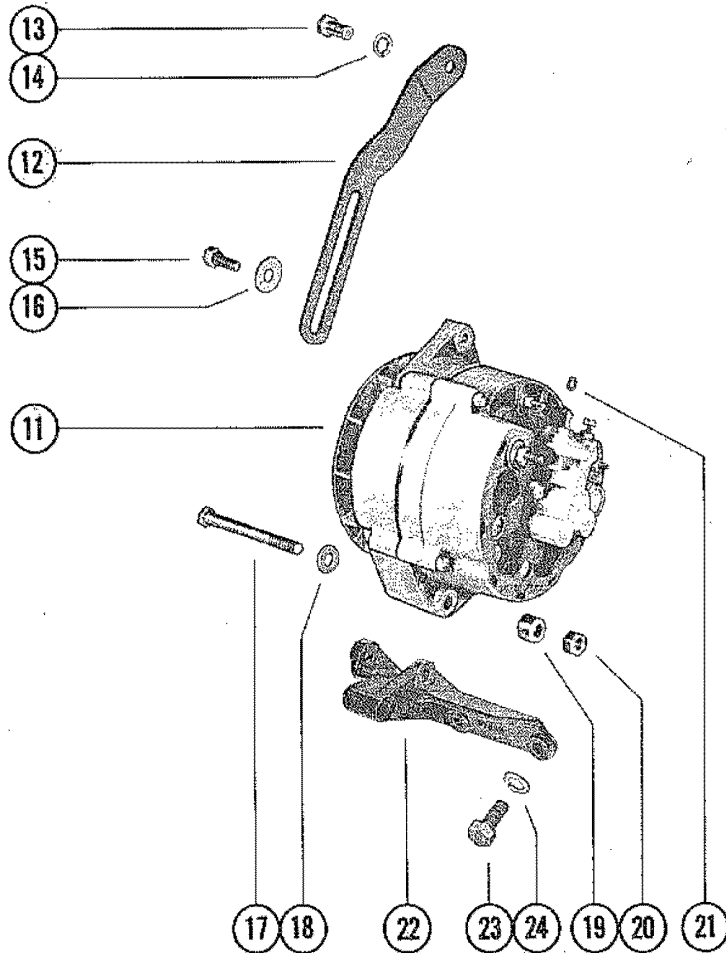
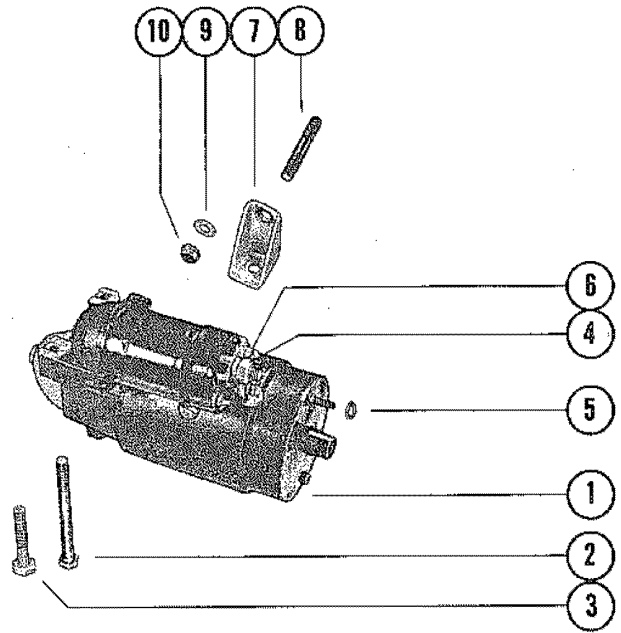

STARTER MOTOR AND ALTERNATOR

REF. NO.	PART NO.	SYM.	QTY.	DESCRIPTION
1	50-45120		1	STARTER MOTOR SEE NOTE
2	10-34545		1	BOLT, STARTER MOTOR MOUNTING (4 21/32")
3	10-34544		1	BOLT, STARTER MOTOR MOUNTING 91 27/32")
4	11-26419		1	NUT, SOLENOID SWITCH TERMINAL (8-32)
5	13-26995		1	LOCKWASHER, STARTER MOTOR TERMINAL
6	11-28517		1	NUT, SOLENOID SWITCH TERMINAL (3/8-16)
7	52250		1	BRACE, STARTER MOTOR
8	16-52387		2	STUD, STARTER MOTOR BRACE MOUNTING
9	12-20103		2	WASHER, STARTER MOTOR BRACE STUD
10	11-35814		2	NUT, STARTER MOTOR BRACE STUD
11	37615A1		1	ALTERNATOR ASSEMBLY SEE NOTE
12	39995		1	BRACE, ALTERNATOR TO CYLINDER BLOCK
13	10-38837		1	SCREW, ALTERNATOR BRACE TO CYLINDER BLOCK (1 1/8")
14	13-26993		1	LOCKWASHER, ALTERNATOR BRACE SCREW
15	10-29198		1	SCREW, ALTERNATOR BRACE TO ALTERNATOR (7/8")
16	12-26168		1	WASHER, ALTERNATOR BRACE SCREW
17	10-32775		1	SCREW, ALTERNATOR TO BRACKET (3 1/2")
18	12-20553		AR	WASHER, ALTERNATOR SCREW
19	23-33186		1	SPACER, ALTERNATOR SCREW
20	11-23161		1	NUT, ALTERNATOR SCREW
21	12-20192		1	WASHER, ALTERNATOR GROUND TERMINAL
22	39998		1	BRACKET, ALTERNATOR MOUNTING
23	10-26632		2	SCREW, ALTERNATOR BRACKET TO CYLINDER BLOCK (1 1/4")
24	13-37459		2	LOCKWASHER, ALTERNATOR MOUNTING BRACKET SCREW

DISTRIBUTOR ASSEMBLY AND COIL

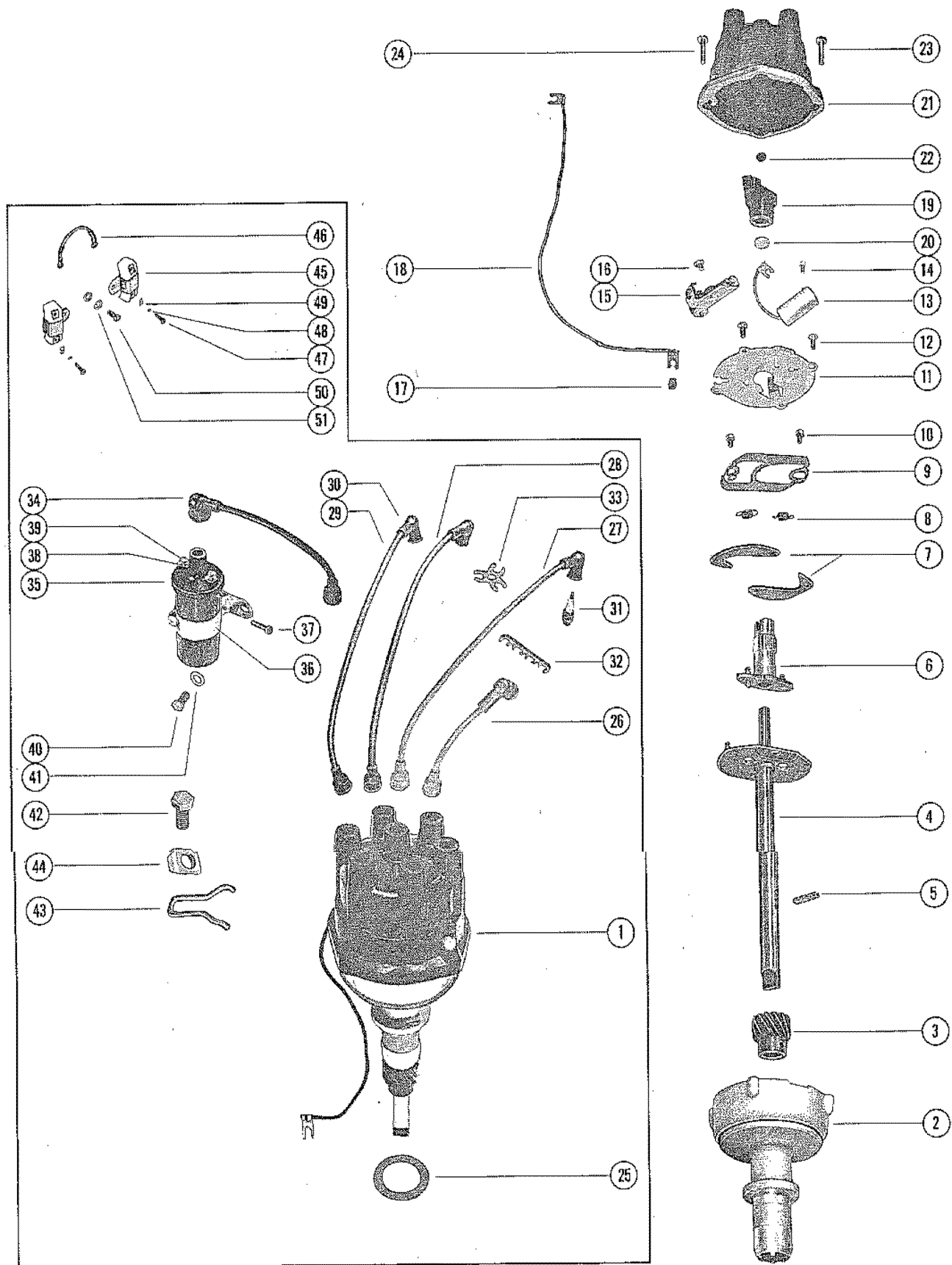

DISTRIBUTOR ASSEMBLY AND COIL

REF. NO.	PART NO.	SYM.	QTY.	DESCRIPTION
1	52277		1	DISTRIBUTOR ASSEMBLY, COMPLETE
2	33668		1	HOUSING, PRIMARY - DISTRIBUTOR
3	43-33664		1	GEAR, DRIVE - MAIN SHAFT
4	52278		1	MAIN SHAFT AND WEIGHT PLATE
5	17-33649		1	PIN, DRIVE GEAR TO MAIN SHAFT
6	52279		1	CAM, BREAKER - ADVANCE
	33653		1	FELT, BREAKER CAM LUBRICATOR
	33670		1	RETAINER, BREAKER CAM ADVANCE
7	33651		2	WEIGHT, BREAKER CAM ADVANCE
8	24-52280		2	SPRING, BREAKER CAM ADVANCE WEIGHT
9	33655		1	PLATE, WEIGHT HOLD DOWN
10	10-33656		2	SCREW, WEIGHT HOLD DOWN PLATE TO WEIGHT PLATE
11	33665		1	PLATE, MOUNTING - BREAKER ASSEMBLY AND CONDENSER
12	10-33648		2	SCREW, MOUNTING PLATE TO PRIMARY HOUSING (3/8")
13	33662		1	CONDENSER
	48024		1	BRACKET, CONDENSER MOUNTING
14	10-48021		1	SCREW, CONDENSER BRACKET ATTACHING
15	34235		1	BREAKER ASSEMBLY, DISTRIBUTOR
16	10-33650		1	SCREW, BREAKER ASSEMBLY TO MOUNTING PLATE (5/32")
17	25-33666		1	GROMMET, MOUNTING PLATE - PRIMARY WIRE
18	48025		1	LEAD, PRIMARY
19	33659		1	ROTOR, DISTRIBUTOR
20	12-36275		1	WASHER, ROTOR
21	33765		1	CAP, DISTRIBUTOR
22	33654		1	BUTTON, CARBON - DISTRIBUTOR CAP
23	10-33660		1	SCREW, DISTRIBUTOR CAP TO PRIMARY HOUSING (8-32)
24	10-33663		1	SCREW, DISTRIBUTOR CAP TO PRIMARY HOUSING (10-32)
25	27-34486		1	GASKET, DISTRIBUTOR
26	32762A1		2	LEAD ASSEMBLY, HIGH TENSION - DISTRIBUTOR (6 1/4")
27	32762A2		1	LEAD ASSEMBLY, HIGH TENSION - DISTRIBUTOR (14 1/4")
28	32762A3		1	LEAD ASSEMBLY, HIGH TENSION - DISTRIBUTOR (20 3/4")
29	32762A4		2	LEAD ASSEMBLY, HIGH TENSION - DISTRIBUTOR (22")
30	47604A1		6	PROTECTOR, HIGH TENSION LEAD
	393-1275		6	SLEEVE, TERMINAL END COVER
31	33-54527		6	SPARK PLUG (AC#CR-44N)
32	32784		1	RETAINER, HIGH TENSION LEADS
33	32783		1	RETAINER, HIGH TENSION LEADS
34	32763A1		1	WIRE ASSEMBLY, DISTRIBUTOR TO COIL (8 1/4")
35	26433		1	COIL ASSEMBLY, IGNITION
36	33321		1	BRACKET, IGNITION COIL MOUNTING
37	10-33311		1	SCREW, MOUNTING BRACKET TO IGNITION COIL
38	12-30164		2	WASHER, IGNITION COIL TERMINAL

CONTINUED ON NEXT PAGE ➡

DISTRIBUTOR ASSEMBLY AND COIL

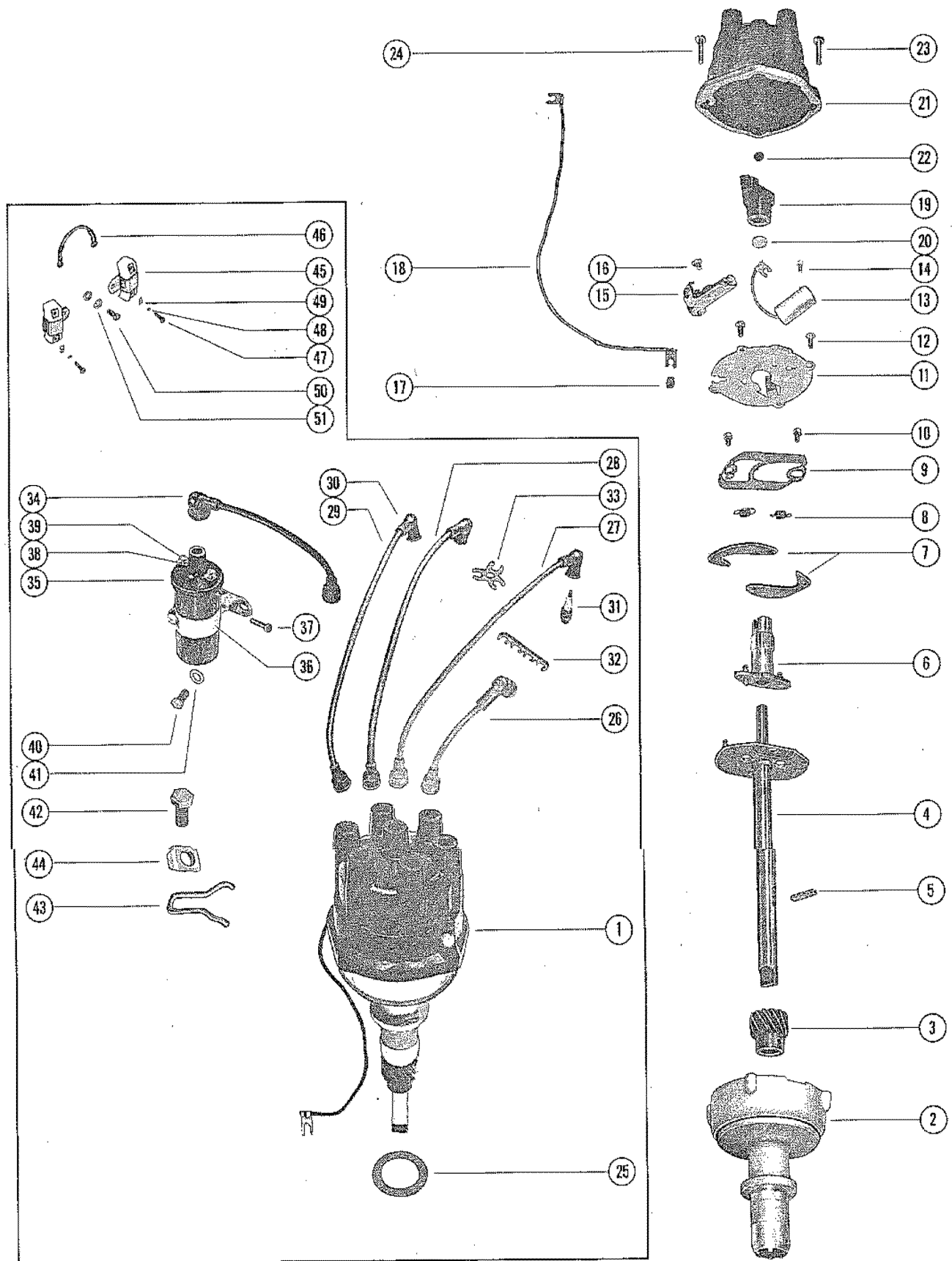

DISTRIBUTOR ASSEMBLY AND COIL

REF. NO.	PART NO.	SYM.	QTY.	DESCRIPTION
38	13-26996		2	LOCKWASHER, IGNITION COIL TERMINAL
39	11-20645		2	NUT, IGNITION TERMINAL
40	10-27165		1	SCREW, IGNITION COIL TO CYLINDER BLOCK (3/4")
41	12-20553		1	WASHER, IGNITION COIL SCREW
42	10-35169		1	SCREW, DISTRIBUTOR TO CYLINDER BLOCK (1")
43	34480		1	CLAMP UNIT, DISTRIBUTOR
44	34549		1	RETAINER, DISTRIBUTOR CLAMP UNIT
45	393-1286		2	BALLAST
46	33210		1	JUMPER WIRE, BALLAST TO BALLAST
47	10-46718		4	SCREW, WIRING HARNESS LEADS TO BALLAST (3/4")
48	13-26995		4	LOCKWASHER, WIRING HARNESS LEADS SCREW
49	12-30191		4	WASHER, WIRING HARNESS LEADS SCREW
50	10-20031		1	SCREW, BALLAST TO FLYWHEEL HOUSING (1/2") SERIAL 00000000-02494935
	10-35585		1	SCREW, BALLAST TO FLYWHEEL HOUSING (3/4") SERIAL 02494936-09999999
51	12-28927		1	WASHER, BALLAST SCREW

FUEL PUMP, CARBURETOR AND THROTTLE LINKAGE

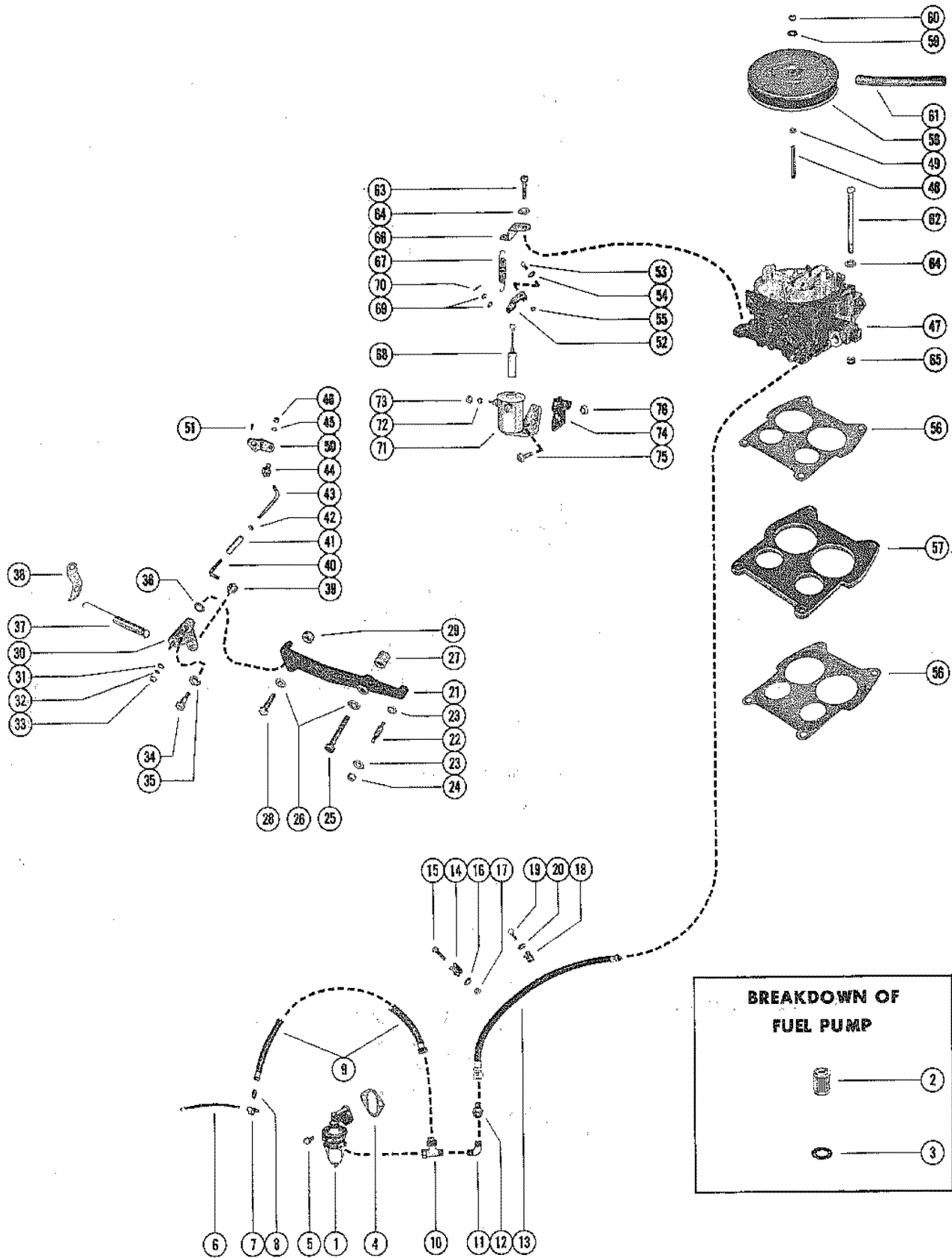

FUEL PUMP, CARBURETOR AND THROTTLE LINKAGE

REF. NO.	PART NO.	SYM.	QTY.	DESCRIPTION
1	47585		1	FUEL PUMP ASSEMBLY (NOT AS SHOWN)
2	35-49088		1	FILTER, FUEL - FUEL PUMP
3	49089		1	DIAPHRAGM KIT, FUEL PUMP
4	27-34213		1	GASKET, FUEL PUMP
5	10-45488		2	SCREW, FUEL PUMP TO CYLINDER BLOCK (3/4")
6	32-30466		1	FUEL LINE, FUEL TANK TO FUEL PUMP
7	22-28624		1	TEE, FITTING - FUEL PUMP THE PARTS HAVE BEEN ELIMINATED ON LATER PRODUCTION ENGINES
8	22-45122		1	CHECK VALVE, FUEL LINE THE PARTS HAVE BEEN ELIMINATED ON LATER PRODUCTION ENGINES
9	32-45121		1	FUEL LINE, RETURN - FUEL PUMP THE PARTS HAVE BEEN ELIMINATED ON LATER PRODUCTION ENGINES
10	22-49210A1		1	TEE ASSEMBLY, FUEL LINE THE PARTS HAVE BEEN ELIMINATED ON LATER PRODUCTION ENGINES
11	22-49217		1	FITTING, FUEL LINE TEE THE PARTS HAVE BEEN ELIMINATED ON LATER PRODUCTION ENGINES
	22-49676		1	ELBOW, FUEL PUMP TO FUEL LINE (OUTLET)
12	22-48439		1	ADAPTOR, OUTLET ELBOW TO FUEL LINES
13	32-52461		1	FUEL LINE, FUEL PUMP TO CARBURETOR (42")
14	54-28938		1	CLAMP, FUEL LINE TO CYLINDER BLOCK
15	10-29199		1	SCREW, FUEL LINE CLAMP FASTENING (1")
16	12-24662		1	WASHER, FUEL LINE CLAMP SCREW
17	11-20890		1	NUT, FUEL LINE CLAMP SCREW
18	54-28938		1	CLAMP, FUEL LINE ATTACHING SERIAL 00000000-02494935
19	10-25703		1	SCREW, FUEL LINE CLAMP FASTENING (1/2") SERIAL 00000000-02494935
20	13-37459		1	LOCKWASHER, FUEL LINE CLAMP SCREW SERIAL 00000000-02494935
21	52124		1	BRACKET, MOUNTING - THROTTLE LINKAGE
22	16-38525		1	STUD, ANCHOR - THROTTLE CABLE TO MOUNTING BRACKET
23	12-24664		2	WASHER, THROTTLE CABLE ANCHOR STUD
24	11-20586		1	NUT, THROTTLE CABLE ANCHOR STUD
25	10-52447		1	BOLT, MOUNTING BRACKET TO EXHAUST MANIFOLD (2 1/4")
26	13-39107		2	LOCKWASHER, MOUNTING BRACKET BOLT
27	23-52096		1	SPACER, MOUNTING BRACKET TO EXHAUST MANIFOLD (3/4")
28	10-31984		1	BOLT, MOUNTING BRACKET TO EXHAUST MANIFOLD (1 1/4")
29	23-52095		1	SPACER, MOUNTING BRACKET TO EXHAUST MANIFOLD (5/16")
30	38979		1	LEVER, THROTTLE - MOUNTING BRACKET
31	12-35950		1	WASHER, THROTTLE LEVER STUD (7/16" O.D.)
32	12-30164		1	WASHER, THROTTLE LEVER STUD (3/8" O.D.)
33	11-20110		1	NUT, THROTTLE LEVER STUD
34	10-38507		1	SCREW, STEP - THROTTLE LEVER TO MOUNTING BRACKET
35	12-53510		1	WASHER, THROTTLE LEVER STEP SCREW (21/64" O.D.)
36	12-20553		1	WASHER, THROTTLE LEVER STEP SCREW (3/8" O.D.)

CONTINUED ON NEXT PAGE ➡

FUEL PUMP, CARBURETOR AND THROTTLE LINKAGE

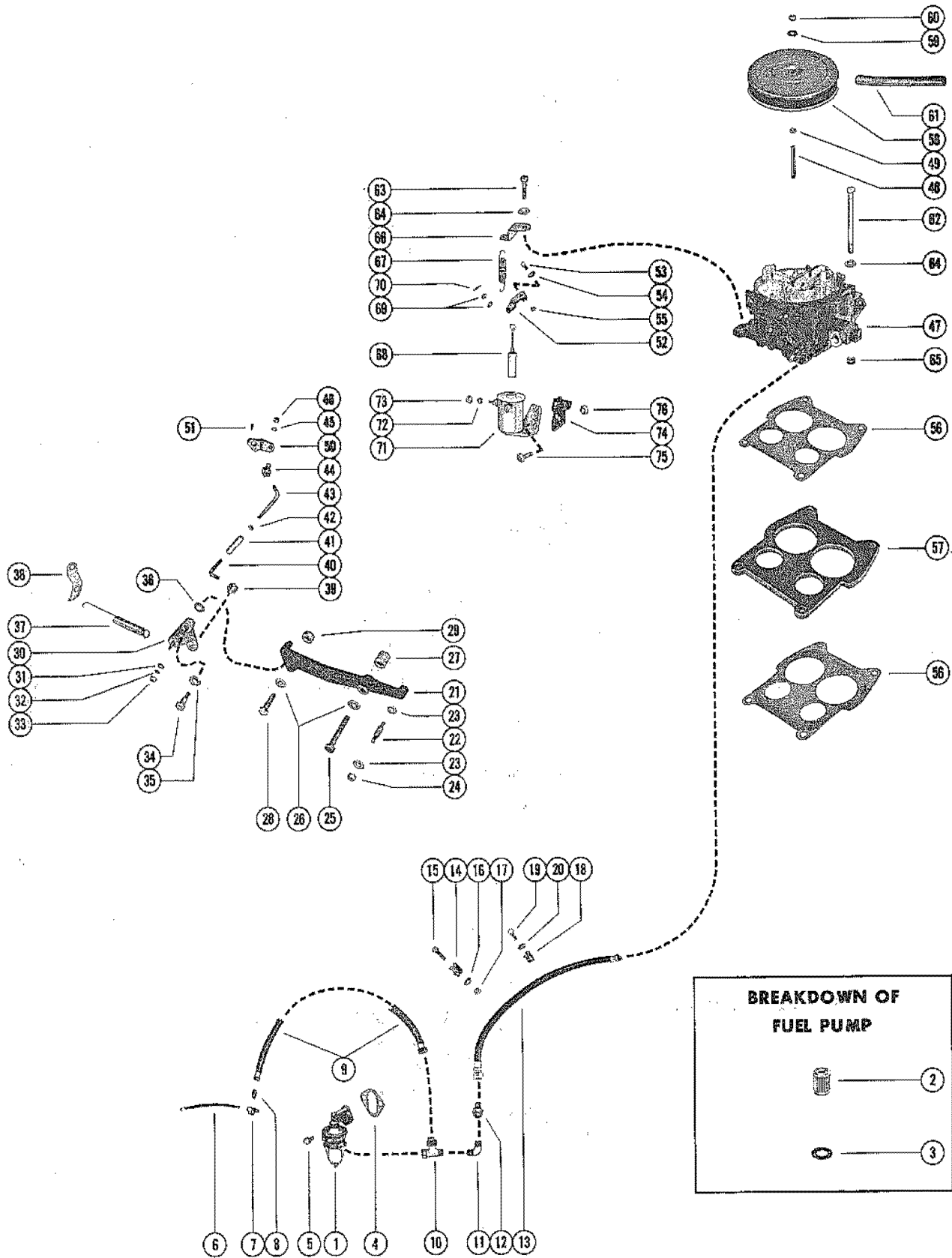

FUEL PUMP, CARBURETOR AND THROTTLE LINKAGE

REF. NO.	PART NO.	SYM.	QTY.	DESCRIPTION
37	24-52082		1	SPRING, THROTTLE RETURN SERIAL 00000000-02494935
38	52392		1	TAB, RETAINER - THROTTLE RETURN SPRING SERIAL 00000000-02494935
37	24-54217		1	SPRING, THROTTLE RETURN SERIAL 02494936-09999999
38	26551		1	TAB, RETAINER RETURN SPRING SERIAL 02494936-09999999
39	27947		1	SWIVEL, LINK ROD TO THROTTLE LEVER
40	52081		1	LINK ROD, THROTTLE SERIAL 00000000-02494935
	54218		1	LINK ROD, THROTTLE SERIAL 02494936-09999999
41	33393		1	SLEEVE, ADJUSTING - THROTTLE LINK ROD
42	11-25168		1	NUT, JAM - THROTTLE LINK ROD
43	33394		1	LINK ROD, CARBURETOR
44	38983		1	SWIVEL, LINK ROD TO CARBURETOR
45	12-30164		1	WASHER, LINK ROD TO CARBURETOR SWIVEL
46	11-20110		1	NUT, LINK ROD TO CARBURETOR SWIVEL
47	1347-3237A2		1	CARBURETOR ASSEMBLY SEE A12 FOR SERIAL 00000000-02494935
	16-33213		1	CARBURETOR ASSEMBLY SEE A12 FOR SERIAL 00249436-09999999
48	16-33213		1	STUD, FLAME ARRESTOR MOUNTING - CARBURETOR
49	11-28941		1	NUT, JAM - FLAME ARRESTOR MOUNTING STUD (BOTTOM)
50	52470		1	LEVER, THROTTLE - CARBURETOR SERIAL 00000000-02494935
	54216		1	LEVER, THROTTLE - CARBURETOR SERIAL 02494936-09999999
51	17-49489		2	RIVET, THROTTLE LEVER TO CARBURETOR
52	52730		1	LEVER, CHOKE - CARBURETOR
53	10-27379		1	SCREW, CHOKE LEVER TO CARBURETOR (3/8") SERIAL 00000000-02494935
	10-27881		1	SCREW, CHOKE LEVER TO CARBURETOR (3/8") SERIAL 02494936-09999999
54	13-26994		1	LOCKWASHER, CHOKE LEVER SCREW
55	11-21270		1	NUT, CHOKE LEVER SCREW
56	27-52457		2	GASKET, CARBURETOR
57	52091		1	PLATE, TUNING
58	47834		1	FLAME ARRESTOR, CARBURETOR (NOT AS SHOWN)
59	12-22937		1	WASHER, FLAME ARRESTOR MOUNTING STUD
60	11-20586		1	NUT, FLAME ARRESTOR MOUNTING STUD (TOP)
61	32-46751A1		1	HOSE ASSEMBLY, VENT - FLAME ARRESTOR TO ROCKER COVER SERIAL 00000000-02494935
	32-47996		1	HOSE, VENT - FLAME ARRESTOR TO ROCKER COVER (9 3/4") SERIAL 02494936-09999999
	54-53101		2	CLAMP, VENT HOSE TO FITTING
62	10-52909		2	SCREW, CARBURETOR TO EXHAUST MANIFOLD (4 3/4")
63	10-20362		2	SCREW, CARBURETOR TO EXHAUST MANIFOLD (1 1/2")
64	12-26825		4	WASHER, CARBURETOR SCREW

CONTINUED ON NEXT PAGE ➡

FUEL PUMP, CARBURETOR AND THROTTLE LINKAGE

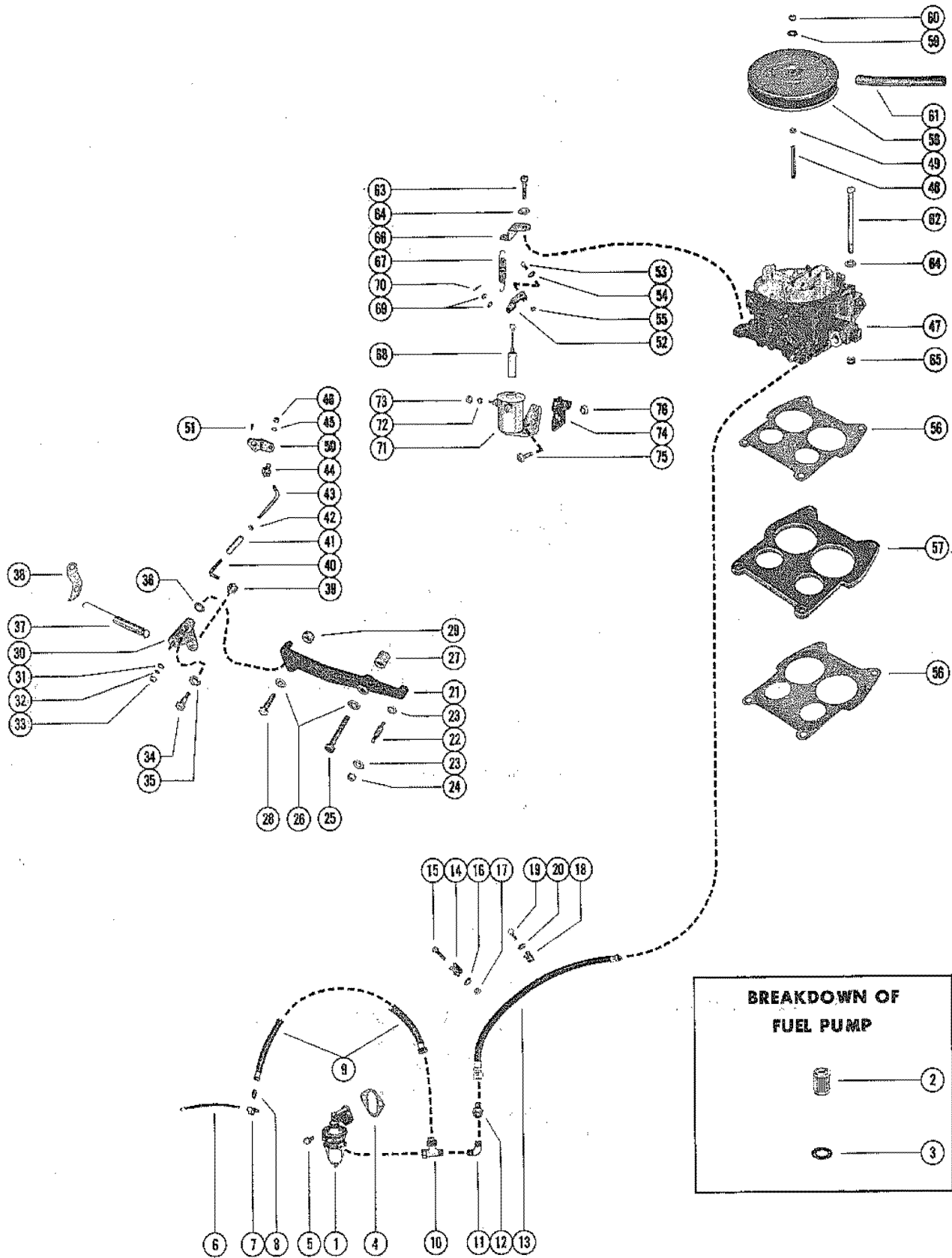

FUEL PUMP, CARBURETOR AND THROTTLE LINKAGE

REF. NO.	PART NO.	SYM.	QTY.	DESCRIPTION
65	11-46793		2	NUT, CARBURETOR SCREW (FRONT)
66	52729		1	TAB, RETAINER - CHOKE RETURN SPRING
67	24-52728		1	SPRING, CHOKE RETURN
68	48315A4		1	PLUNGER AND LINK ASSEMBLY, CHOKE SOLENOID
69	12-38833		2	WASHER, PLUNGER AND LINK
70	18-26953		1	COTTER PIN, PLUNGER AND LINK TO CHOKE LEVER
71	52667		1	CHOKE SOLENOID
72	13-26996		2	LOCKWASHER, CHOKE SOLENOID TERMINAL
73	11-20645		2	NUT, CHOKE SOLENOID TERMINAL
74	52726		1	BRACKET, MOUNTING - CHOKE SOLENOID
75	10-21625		2	SCREW, CHOKE SOLENOID TO MOUNTING BRACKET (3/4")
76	11-35888		2	NUT, CHOKE AND SOLENOID SCREW

CARBURETOR ASSEMBLY, COMPLETE

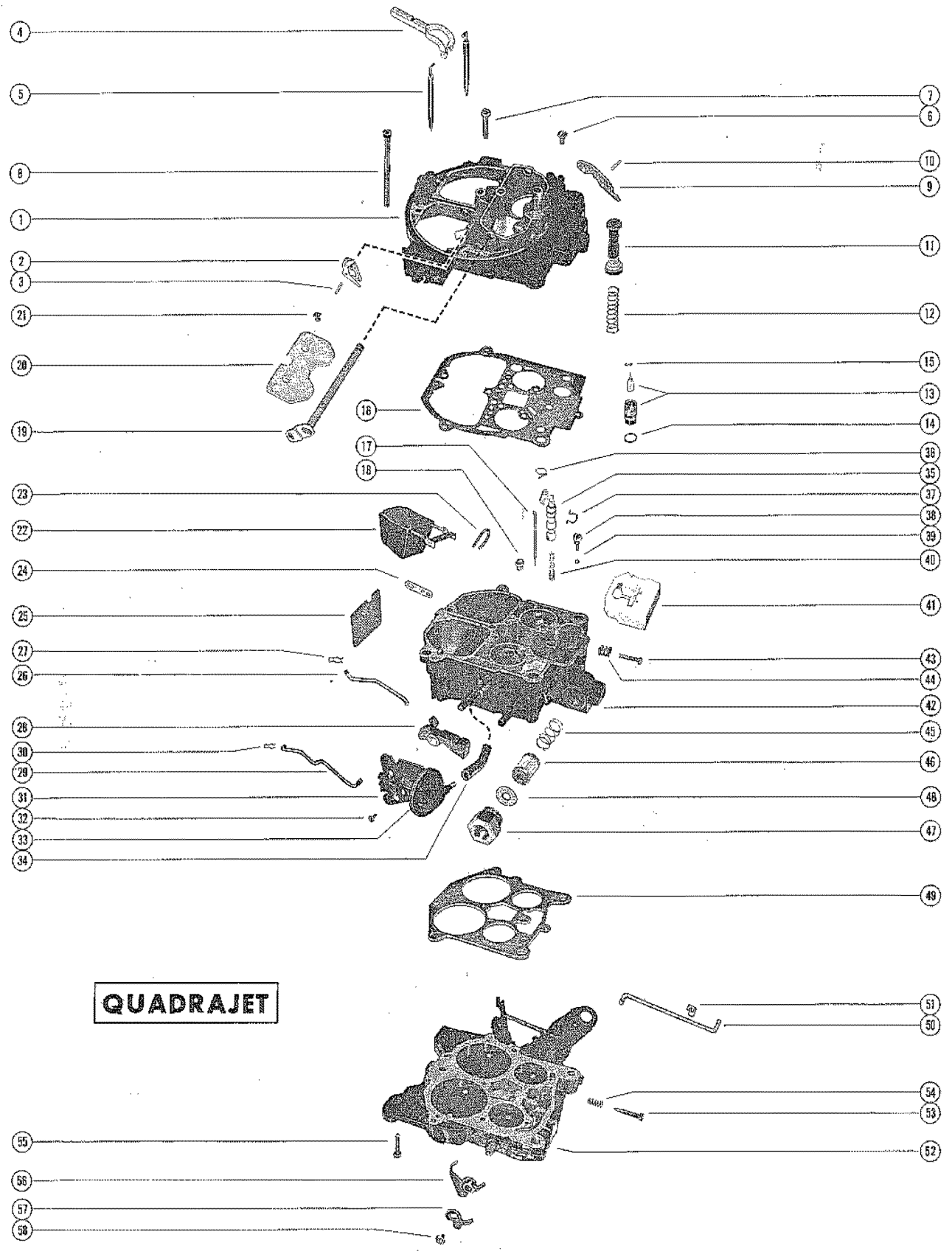

CARBURETOR ASSEMBLY, COMPLETE

REF. NO.	PART NO.	SYM.	QTY.	DESCRIPTION
-	1347-3237A2		1	CARBURETOR ASSEMBLY, COMPLETE SERIAL 0000000-02494935
-	1347-3237A4		1	CARBURETOR ASSEMBLY, COMPLETE SERIAL 02494936-09999999
1	1397-3337		1	AIR HORN ASSEMBLY
2	1397-3314		1	LEVER, AIR VALVE LOCKOUT
3			1	ROLL PIN, LOCKOUT LEVER
4	1397-3313		1	HOLDER KIT, SECONDARY METERING ROD
5	1397-3338		2	METERING ROD, SECONDARY
6	10-48137		2	SCREW, AIR HORN TO FLOAT BOWL (3/8")
7	10-34370		5	SCREW, AIR HORN TO FLOAT BOWL (1")
8	10-48395		2	SCREW, AIR HORN TO FLOAT BOWL (3")
9	1397-3311		1	LEVER, ACTUATING - PUMP
10			1	ROLL PIN, HINGE - PUMP LEVER
11			1	PUMP ASSEMBLY
12			1	SPRING, PUMP RETURN
13			1	NEEDLE AND SEAT ASSEMBLY
14			1	GASKET, NEEDLE AND SEAT
15			1	PULL CLIP, FLOAT NEEDLE
16			1	GASKET, AIR HORN
17			2	METERING ROD, PRIMARY
18			2	JET, PRIMARY
19	1397-3321		1	CHOKE SHAFT AND LEVER ASSEMBLY
20	1397-3631		1	VALVE, CHOKE - CHOKE SHAFT
21	10-48139		2	SCREW, CHOKE VALVE TO CHOKE SHAFT
22	1397-3327		1	FLOAT ASSEMBLY
23	17-48140		1	PIN, HINGE - FLOAT
24	1397-3323		1	LEVER, INTERMEDIATE CHOKE
25	1397-3341		1	BAFFLE, FLOAT BOWL
26	1397-3324		1	ROD, CHOKE
27			1	CLIP, CHOKE ROD
28	1397-3319		1	CAM, FAST IDLE
29	1397-3318		1	ROD, VACUUM CONTROL
30			1	CLIP, VACUUM CONTROL ROD
31	1397-3339		1	BRACKET ASSEMBLY, VACUUM CONTROL
32	10-48138		1	SCREW, VACUUM CONTROL BRACKET TO FLOAT BOWL
33	1397-3340		1	CONTROL ASSEMBLY, VACUUM
34	1397-3320		1	HOSE, VACUUM
35	1397-3328		1	POWER PISTON ASSEMBLY
36	24-48142		1	SPRING, METERING ROD - PRIMARY
37	1397-3329		1	RETAINER, POWER PISTON
38	1397-3326		1	RETAINER, PUMP DISCHARGE BALL
39			1	BALL, PUMP DISCHARGE
40	24-48141		1	SPRING, POWER PISTON

CONTINUED ON NEXT PAGE ➡

CARBURETOR ASSEMBLY, COMPLETE

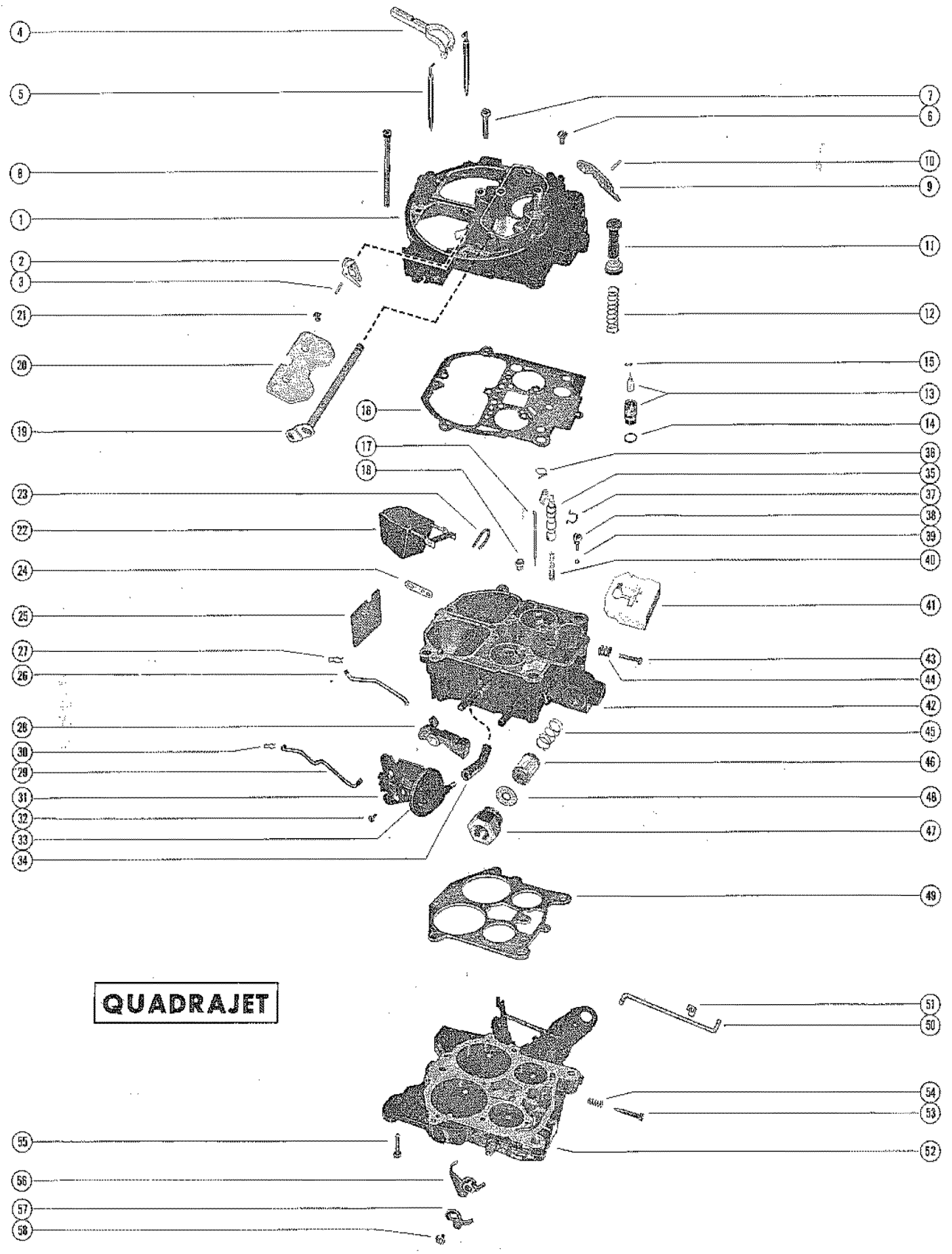

CARBURETOR ASSEMBLY, COMPLETE

REF. NO.	PART NO.	SYM.	QTY.	DESCRIPTION
41	1397-3331		1	INSERT, FLOAT BOWL
42	1397-3325		1	FLOAT BOWL ASSEMBLY
43	10-48144		1	SCREW, IDLE STOP
44	24-34373		1	SPRING, IDLE STOP SCREW
45	24-52727		1	SPRING, FILTER NUT
46	35-53336		1	FILTER, FUEL - CARBURETOR INLET
47	1397-3330		1	NUT, FILTER - FUEL INLET
48			1	GASKET, FILTER NUT
49			1	GASKET, THROTTLE BODY
50	1397-3333		1	ROD, PUMP
51			1	CLIP, PUMP ROD
52	1397-3334		1	THROTTLE BODY ASSEMBLY
53			2	IDLE NEEDLE, THROTTLE BODY
54	24-33050		2	SPRING, IDLE NEEDLE
55	10-48145		3	SCREW, THROTTLE BODY TO FLOAT BOWL
56	1397-3335		1	LEVER, CAM
57	1397-3336		1	LEVER, FAST IDLE
58	10-48146		1	SCREW, LEVER AND CAM TO THROTTLE BODY
-	1397-3315		1	SPRING AND CAM KIT, AIR VALVE
-	1397-3307A1		1	OVERHAUL KIT
-	1397-3309		1	GASKET SET
-	1397-3308		1	OFF ENGINE KIT

EXHAUST MANIFOLD AND EXHAUST ELBOW

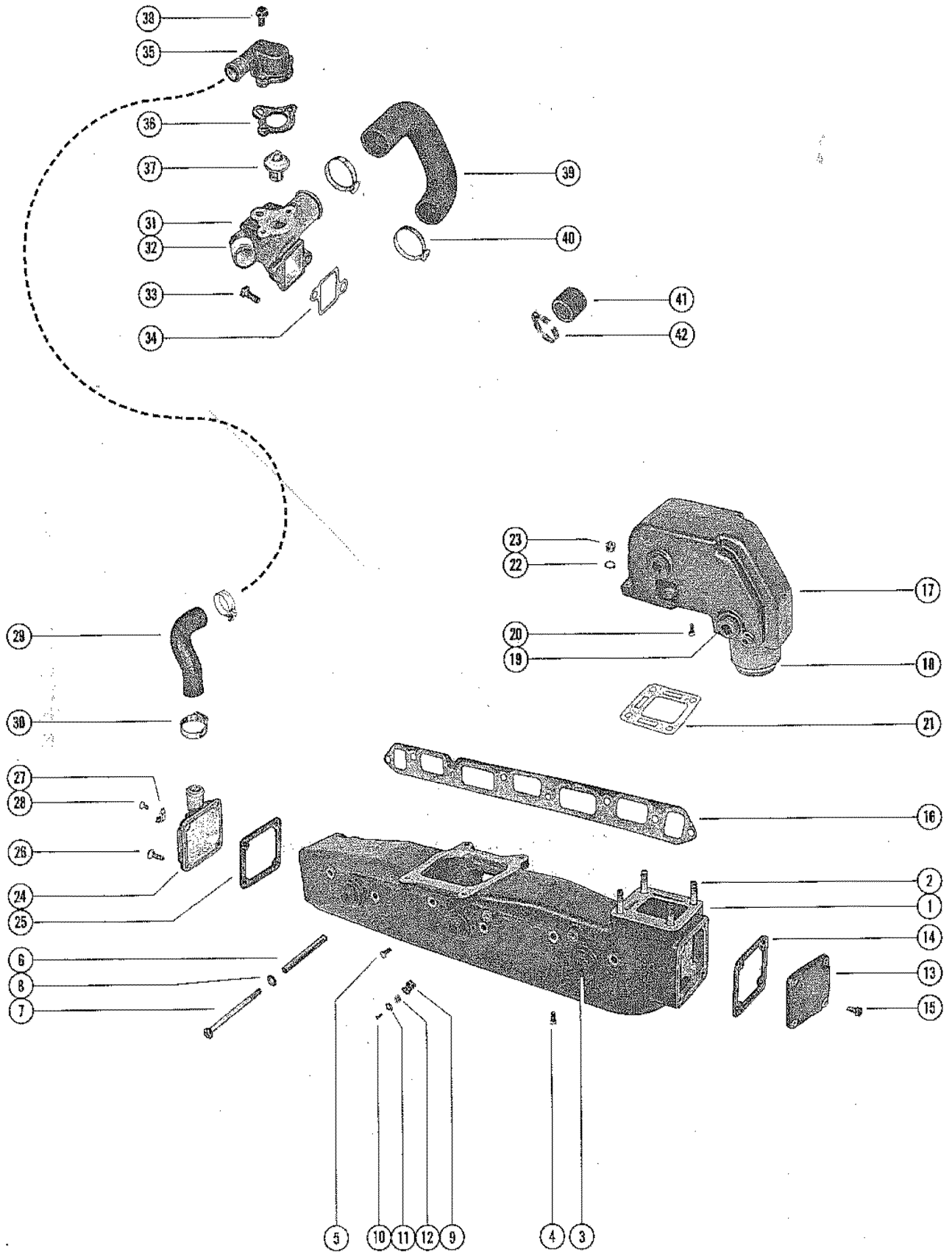

EXHAUST MANIFOLD AND EXHAUST ELBOW

REF. NO.	PART NO.	SYM.	QTY.	DESCRIPTION
1	52073A1		1	EXHAUST MANIFOLD ASSEMBLY
2	16-49545		4	STUD, EXHAUST MANIFOLD TO EXHAUST ELBOW (1 3/4")
3	22-48118		4	PLUG, EXHAUST MANIFOLD
4	22-32802		1	PLUG, PIPE - EXHAUST MANIFOLD (1/8-27)
5	22-32561		1	PLUG, PIPE - EXHAUST MANIFOLD (1/4-18)
6	23-52097		6	SLEEVE, EXHAUST MANIFOLD SCREW
7	10-52143		6	SCREW, EXHAUST MANIFOLD TO CYLINDER HEAD (4 3/4")
8	12-20553		6	WASHER, EXHAUST MANIFOLD SCREW
9	54-22740		2	CLAMP, WIRING HARNESS TO EXHAUST MANIFOLD (3/8")
10	10-22028		2	SCREW, WIRING HARNESS CLAMP FASTENING (1/2")
11	13-26996		2	LOCKWASHER, WIRING HARNESS CLAMP SCREW
12	22789		2	"D" WASHER, WIRING HARNESS CLAMP SCREW
13	48045		1	END CAP, EXHAUST MANIFOLD (REAR)
14	27-48043		1	GASKET, END CAP TO EXHAUST MANIFOLD
15	10-25038		4	SCREW, END CAP TO EXHAUST MANIFOLD (7/8")
16	27-46041		1	GASKET, EXHAUST MANIFOLD TO CYLINDER HEAD
17	49964A1		1	EXHAUST ELBOW ASSEMBLY
18	32-49705		1	TUBE, WATER SEPARATION-EXHAUST ELBOW
19	22-48118		4	PLUG, EXHAUST ELBOW
20	22-32802		1	PLUG, PIPE-EXHAUST ELBOW
21	27-52076		1	GASKET, EXHAUST ELBOW TO EXHAUST MANIFOLD
22	13-37459		4	LOCKWASHER, EXHAUST ELBOW TO EXHAUST MANIFOLD STUD
23	11-49838		4	NUT, EXHAUST ELBOW MANIFOLD STUD
24	48044		1	END CAP/CONNECTOR, EXHAUST MANIFOLD (FRONT)
25	27-48043		1	GASKET, END CAP/CONNECTOR TO EXHAUST MANIFOLD
26	10-25038		4	SCREW, END CAP/CONNECTOR TO EXHAUST MANIFOLD (7/8")
27	54-33361		1	CLIP, WIRING HARNESS RETAINER
28	10-20776		1	SCREW, WIRING HARNESS RETAINING CLIP
29	32-52481		1	HOSE, WATER DISTRIBUTION BLOCK TO END CAP/CONNECTOR
30	54-32880		2	CLAMP, HOSE TO WATER DISTRIBUTION BLOCK AND END CAP CONNECTOR
31	47587A2		1	BLOCK ASSEMBLY, WATER DISTRIBUTION-CYLINDER BLOCK
32	22-52089		1	ELBOW, WATER DISTRIBUTION BLOCK
33	10-21077		2	SCREW, WATER DISTRIBUTION BLOCK TO CYLINDER HEAD (7/8")
34	27-33680		1	GASKET, WATER DISTRIBUTION BLOCK
35	47588		1	COVER, THERMOSTAT-WATER DISTRIBUTION BLOCK
36	27-47590		1	GASKET, THERMOSTAT COVER
37	47594		1	THERMOSTAT
38	10-53512		2	SCREW, THERMOSTAT COVER TO WATER DISTRIBUTION BLOCK (3/4")

CONTINUED ON NEXT PAGE ➡

EXHAUST MANIFOLD AND EXHAUST ELBOW

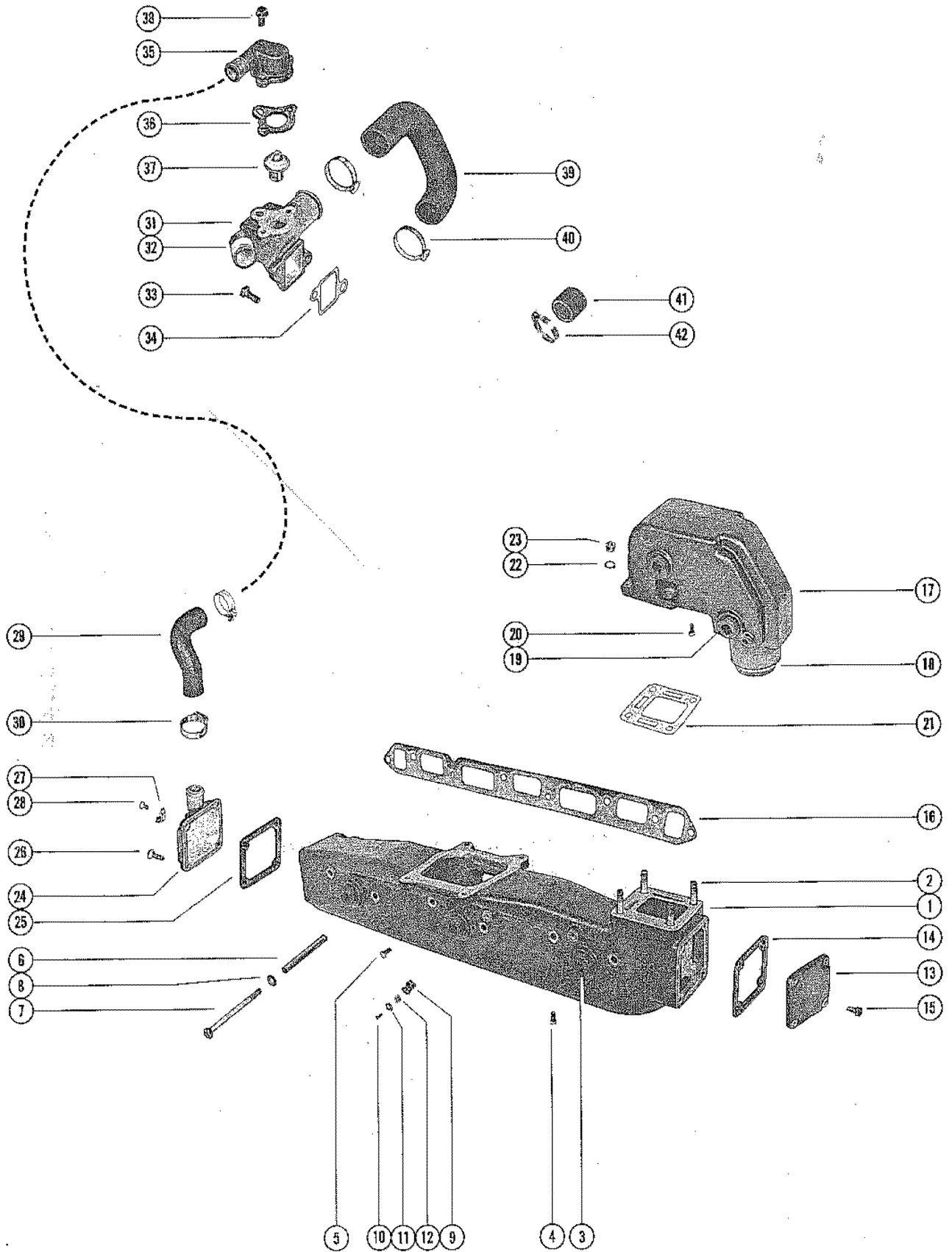

EXHAUST MANIFOLD AND EXHAUST ELBOW

REF. NO.	PART NO.	SYM.	QTY.	DESCRIPTION
39	32-52099		1	HOSE, WATER DISTRIBUTION BLOCK TO WATER PUMP
40	54-32781		2	CLAMP, HOSE T WATER DISTRIBUTION BLOCK AND WATER PUMP
41	32877		1	COVER, WATER PUMP (1 1/16"LONG)
	54684		1	COVER, WATER PUMP (1 3/8"LONG)
42	54-38426		2	CLAMP, WATER PUMP COVER TO WATER PUMP

FLYWHEEL HOUSING

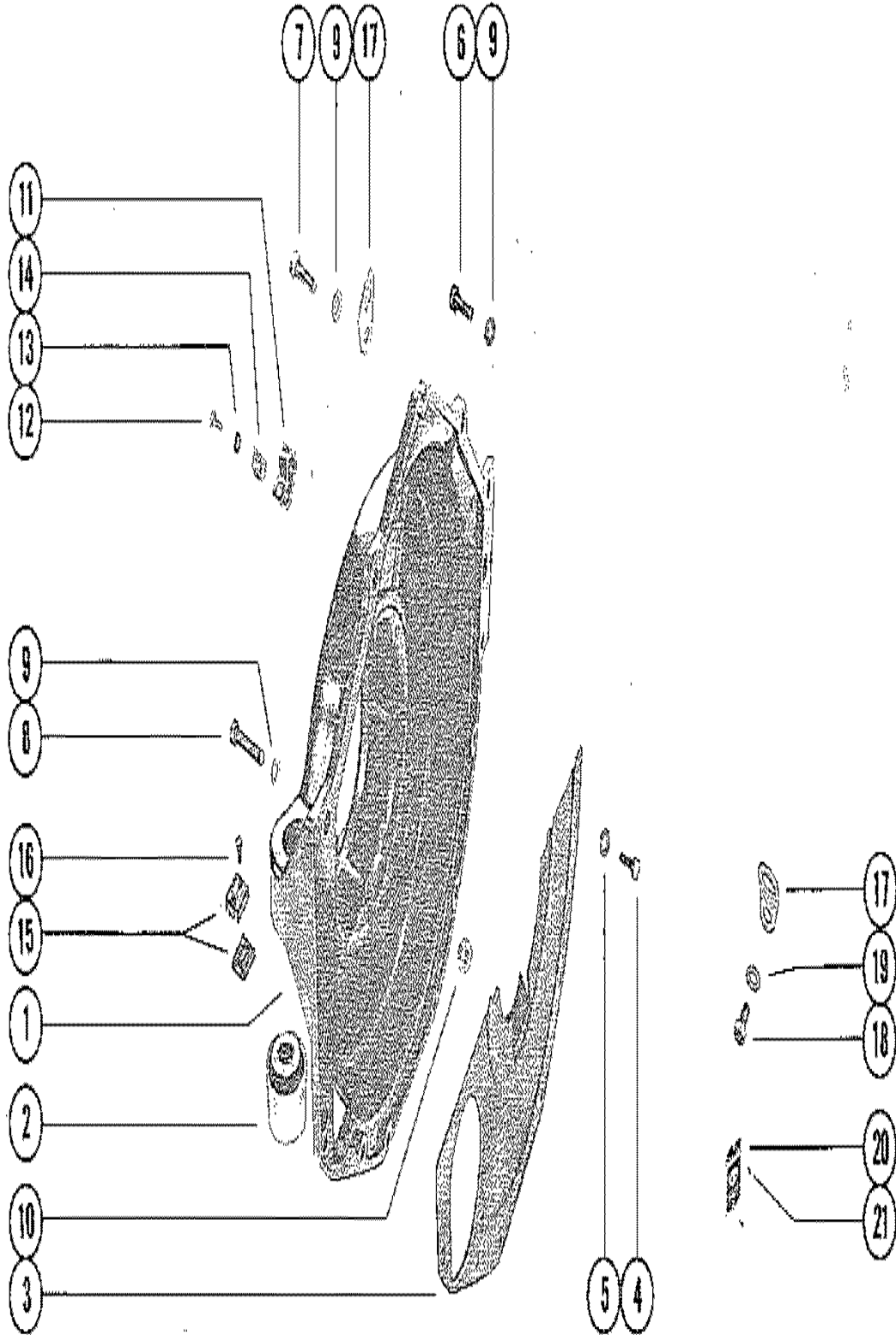

FLYWHEEL HOUSING

REF. NO.	PART NO.	SYM.	QTY.	DESCRIPTION
1	52754		1	HOUSING, FLYWHEEL SERIAL 00000000-02494935
	53652A1		1	HOUSING ASSEMBLY, FLYWHEEL SERIAL 02494936-09999999
2	35852		2	MOUNT, RUBBER-FLYWHEEL HOUSING SERIAL 02494936-09999999
3	35864		1	COVER PLATE, FLYWHEEL HOUSING
4	10-25299		6	SCREW, COVER PLATE TO FLYWHEEL HOUSING (3/4")
5	13-39107		6	LOCKWASHER, COVER PLATE SCREW
6	10-48115		2	SCREW, HOUSING TO BLOCK (3 1/2") SERIAL 00000000-02494935
	10-53734		2	SCREW, HOUSING TO BLOCK (3") SERIAL 02494936-09999999
7	10-48424		3	SCREW, HOUSING TO BLOCK (1 5/8")
8	10-53044		1	SCREW, HOUSING TO BLOCK (2 1/4")
9	13-37459		6	LOCKWASHER, HOUSING SCREW
10	11-28517		1	NUT, HOUSING SCREW
11	54-24871		1	CLAMP, WIRING HARNESS TO HOUSING SERIAL 00000000-02494935
	54-46997		1	CLAMP, WIRING HARNESS TO HOUSING SERIAL 02494936-09999999
12	10-22245		1	SCREW, WIRING HARNESS CLAMP ATTACHING (1/2")
13	13-26996		1	LOCKWASHER, WIRING HARNESS CLAMP SCREW
14	22789		1	"D" WASHER, WIRING HARNESS SCREW
15	39974		2	CONNECTOR, HARNESS LEADS TO FLYWHEEL HOUSING
16	10-37892		2	SCREW, CONNECTOR TO FLYWHEEL HOUSING (7/8")
17	54-34764		2	EYE, LIFTING-CYLINDER BLOCK AND FLYWHEEL HOUSING
18	10-27165		1	SCREW, LIFTING EYE TO CYLINDER BLOCK (3/4")
19	13-37459		1	WASHER, LIFTING EYE SCREW
20	38-31042		1	SERIAL PLATE
21	10-20314		2	SCREW, DRIVE- SERIAL PLATE TO CYLINDER BLOCK (3/16")

ENGINE MOUNTING

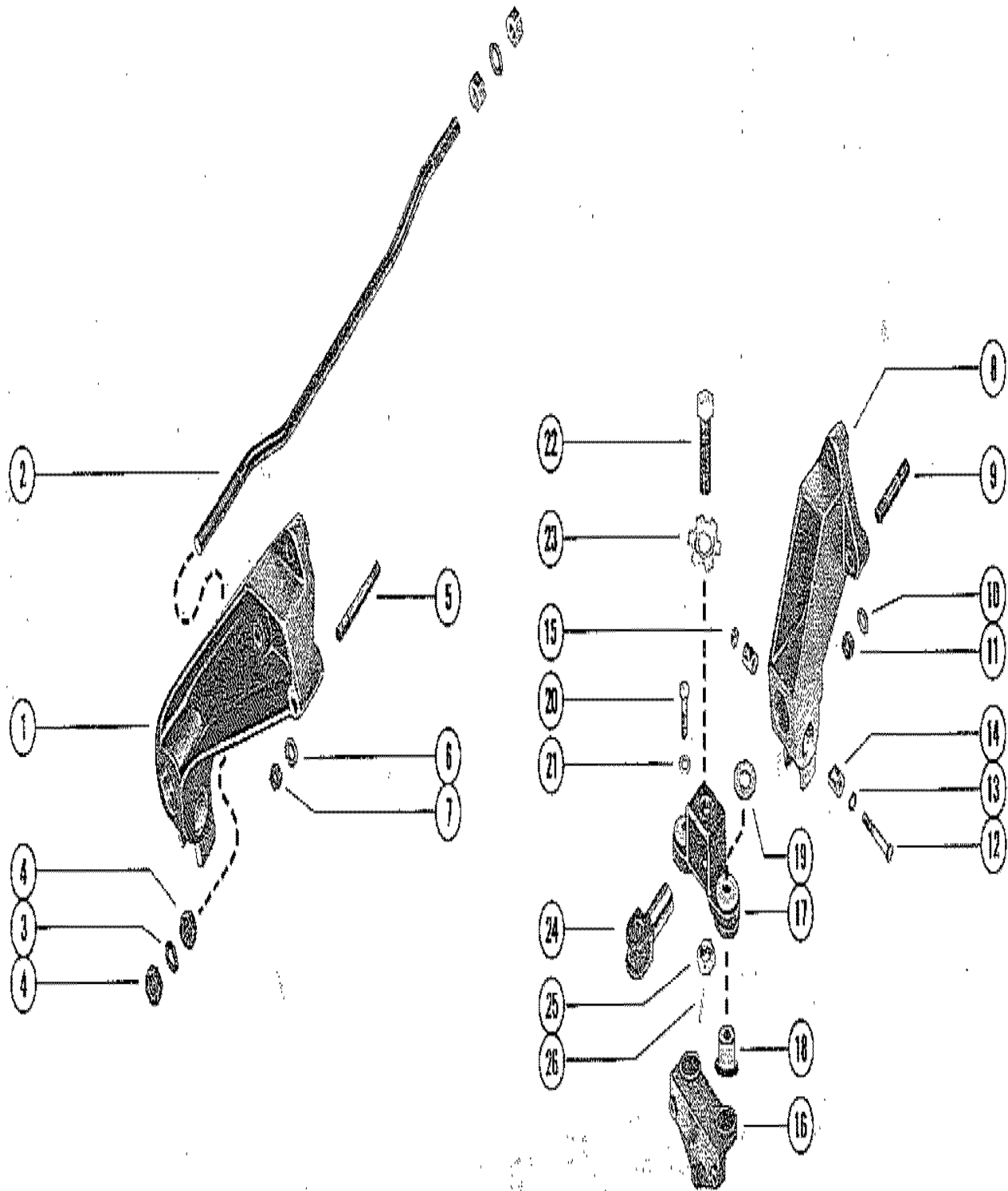

ENGINE MOUNTING

REF. NO.	PART NO.	SYM.	QTY.	DESCRIPTION
1	52134		1	BRACKET, MOUNTING (FRONT-PORT SIDE)
2	52811		1	TIE BAR, FRONT MOUNT CONNECTING
3	13-31848		2	LOCKWASHER, TIE BAR
4	11-52829		4	NUT, TIE BAR FASTENING
5	16-52605		2	STUD, MOUNTING BRACKET TO CYLINDER BLOCK (2")
	16-52606		1	STUD, MOUNTING BRACKET TO CYLINDER BLOCK (2 3/4")
6	13-37459		3	LOCKWASHER, MOUNTING BRACKET STUD
7	11-49838		3	NUT, MOUNTING BRACKET STUD
8	52078		1	BRACKET, MOUNTING (FRONT-STARBOARD SIDE)
9	16-52605		3	STUD, MOUNTING BRACKET TO CYLINDER BLOCK (2")
10	13-37459		3	LOCKWASHER, MOUNTING BRACKET STUD
11	11-49838		3	NUT, MOUNTING BRACKET STUD
12	10-47654		4	SCREW, CLAMP-ADJUSTING TRUNNION (2 3/4")
13	13-32993		4	LOCKWASHER, CLAMP ADJUSTING TRUNNION SCREW
14	54-47528		8	CLAMP, ADJUSTING TRUNNION SCREW
15	11-29553		4	NUT, CLAMP ADJUSTING TRUNNION SCREW
16	47986		4	BRACKET, MOUNTING-ENGINE
17	52139A2		4	BRACKET ASSEMBLY, MOUNTING SERIAL 00000000-02494935
	52139A4		2	BRACKET ASSEMBLY, MOUNTING SERIAL 24994936-09999999
18	47656		8	MOUNT, MOUNTING BRACKET SERIAL 00000000-02494935
	52753		4	MOUNT, MOUNTING BRACKET SERIAL 24994936-09999999
19	12-48611		8	WASHER, MOUNTING BACKET
20	10-48254		8	SCREW, MOUNTING BRACKET ATTACHING (2 1/8")
21	13-31848		8	LOCKWASHER, MOUNTING BRACKET SCREW
22	10-52156		4	SCREW ADJUSTING TRUNNION (4 1/2")
23	14-48467		4	TAB WASHER, ADJUSTER TRUNNION SCREW
24	47518		4	TRUNNION, ADJUSTING-MOUNTING BRACKET
25	11-47525		4	NUT, JAM- ADJUSTING TRUNNION SCREW
26	17-22116		4	PIN, ROLL-JAM NUT

WATER PUMP ASSEMBLY, COMPLETE

BREAKDOWN OF WATER PUMP

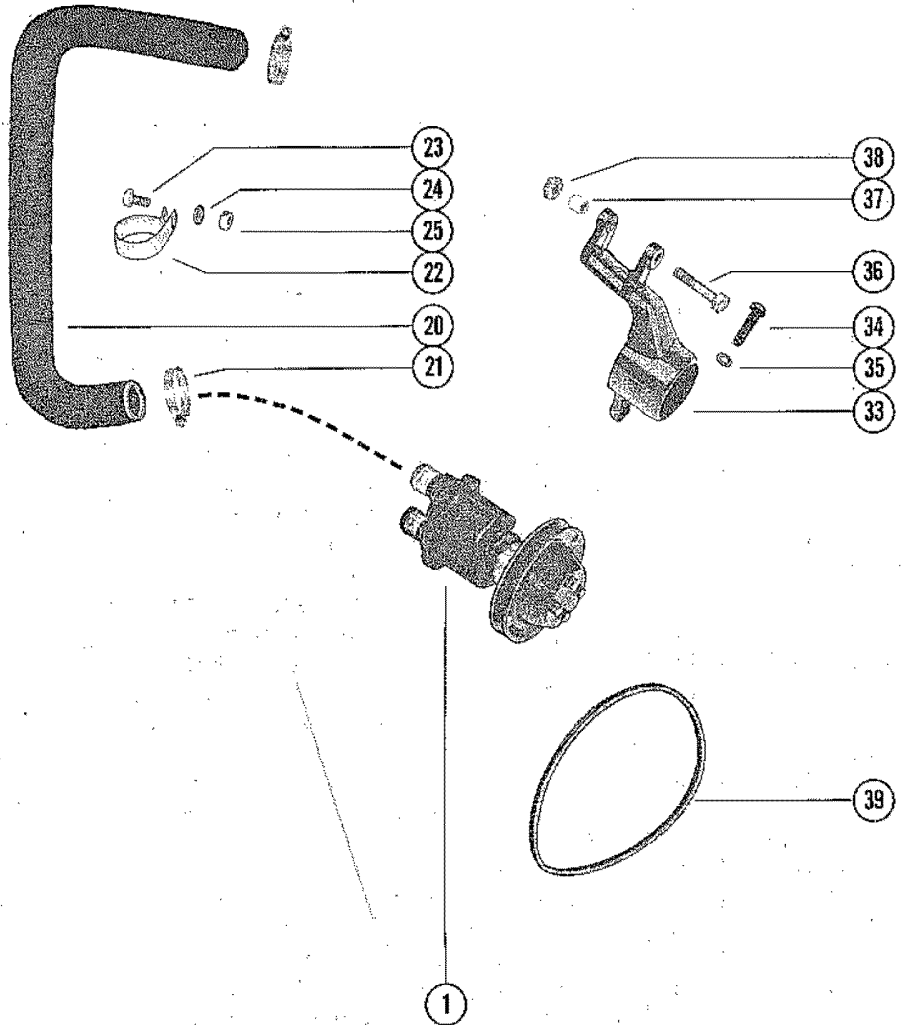
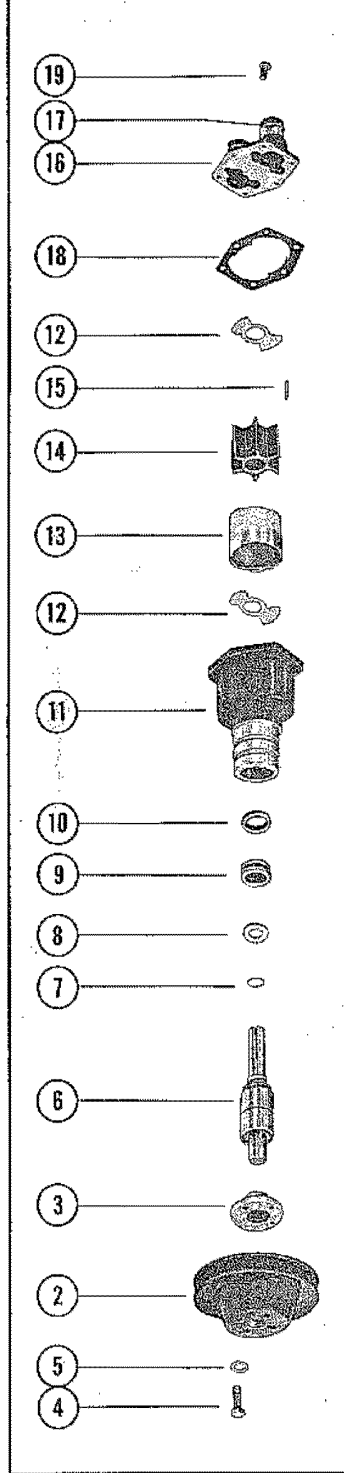

WATER PUMP ASSEMBLY, COMPLETE

REF. NO.	PART NO.	SYM.	QTY.	DESCRIPTION
1	46-47506A1		1	WATER PUMP ASSEMBLY, COMPLETE
2	52822		1	PULLEY, WATER PUMP
3	47530		1	HUB, WATER PUMP PULLEY
4	10-20705		4	SCREW, WATER PUMP PULLEY TO WATER PUMP (3/4")
5	13-39107		4	LOCKWASHER, WATER PUMP PULLEY SCREW
6	47403		1	SHAFT AND BEARING
7	53-47657		1	RING, RETAINING - SGAFT AND BEARING
8	12-47683		1	WASHER, SHAFT AND BEARING
9	26-47401		1	SEAL, MECHANICAL-SHAFT AND BEARING
10	26-47531		1	SEAL, FLOATING-SHAFT AND BEARING
11	46-47506A2		1	BODY ASSEMBLY, WATER PUMP
12	47405		2	WEAR PLATE
13	47529		1	INSERT, WATER PUMP BODY
14	47-47519		1	IMPELLER
15	17-47526		1	PIN, IMPELLER DRIVE
16	47497A1		1	COVER ASSEMBLY, WATER PUMP
17	23-47511		2	SLEEVE, WATER PUMP COVER
18	27-47410		1	GASKET, WATER PUMP COVER TO WATER PUMP BODY
19	10-28635		6	SCREW, WATER PUMP COVER TO WATER PUMP BODY (5/8")
20	23-52133		1	HOSE, WATER PUMP TO THERMOSTAT HOUSING
21	54-32780		2	CLAMP, HOSE TO WATER PUMP AND THERMOSTAT HOUSING
22	54-47715		1	CLIP, HOSE TO EXHAUST MANIFOLD
23	10-27165		1	SCREW, HOSE CLIP TO EXHAUST MANIFOLD
24	13-35048		1	LOCKWASHER, HOSE CLIP SCREW
25	11-28517		1	NUT, HOSE CLIP SCREW
26	49587		1	BRACE, WATER PUMP ADJUSTING
27	10-31381		1	SCREW, ADJUSTING BRACE TO CYLINDER BLOCK (1")
28	13-32993		1	LOCKWASHER, ADJUSTING BRACE SCREW
29	10-26632		1	SCREW, ADJUSTING BRACE TO WATER PUMP BRACKET (1 1/4")
30	12-20553		1	WASHER, ADJUSTING BRACE SCREW
31	13-35048		1	LOCKWASHER, ADJUSTING BRACE SCREW
32	11-28517		1	NUT, ADJUSTING BRACE SCREW
33	49581		1	BRACKET, WATER PUMP
34	10-34354		1	SCREW, WATER PUMP BRACKET CLAMPING (1 1/2")
35	13-35048		1	LOCKWASHER, WATER PUMP BRACKET CLAMPING SCREW
36	10-52409		1	SCREW, WATER PUMP BRACKET T ALTERNATOR BRACKET (3 1/4")
37	23-33186		1	BUSHING, WATER PUMP BRACKET SCREW
38	11-23161		1	NUT, WATER PUMP BRACKET SCREW
39	57-45367		1	BELT, WATER PUMP

CYLINDER BLOCK, PISTON AND CRANKSHAFT

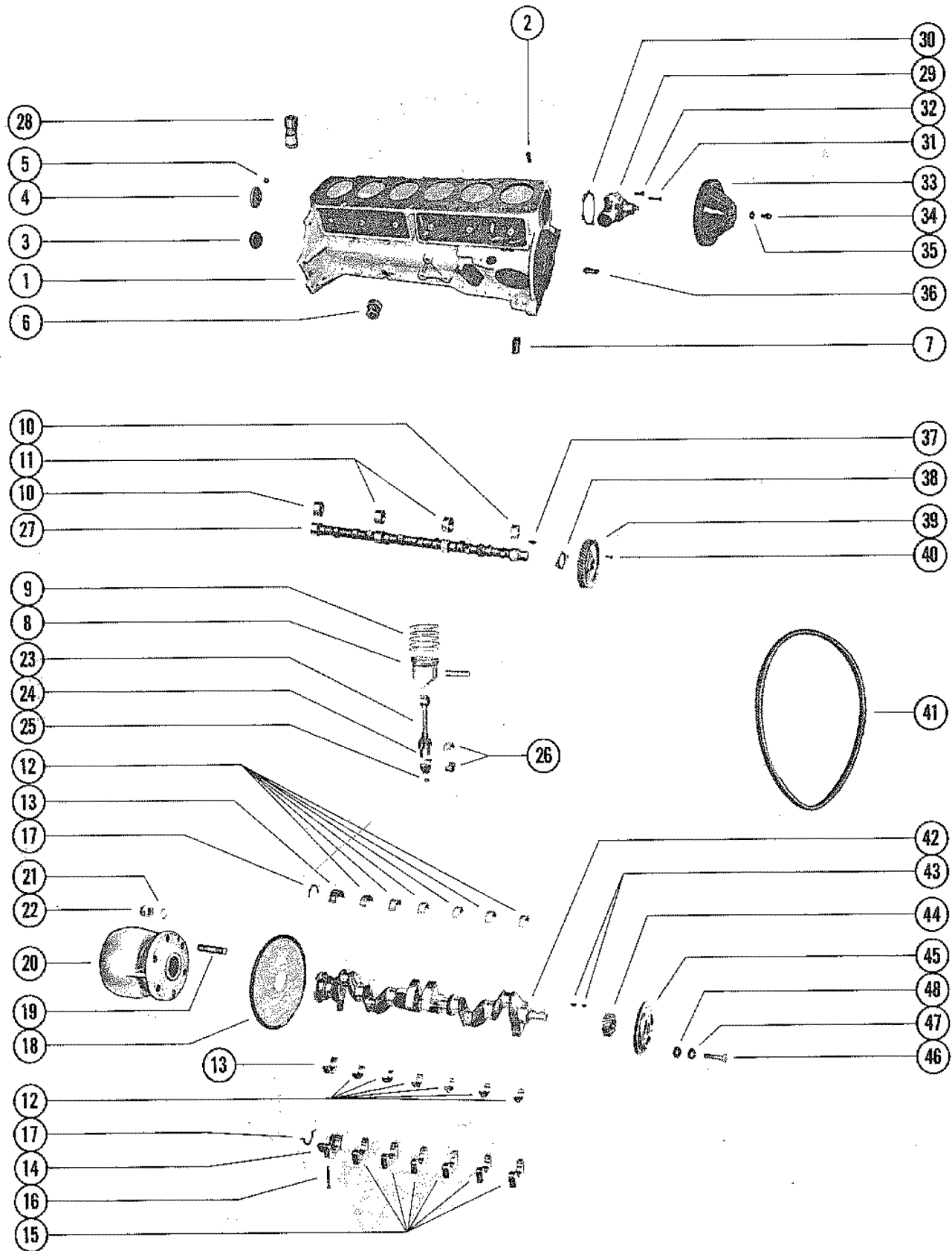

CYLINDER BLOCK, PISTON AND CRANKSHAFT

REF. NO.	PART NO.	SYM.	QTY.	DESCRIPTION
1	840-3658		1	CYLINDER BLOCK ASSEMBLY
2	17-35465		2	PIN, DOWEL-CYLINDER BLOCK TO CYLINDER HEAD
3	19-34270		3	PLUG, EXPANSION-CYLINDER BLOCK (1 5/8"DIA.)
	19-34271		1	PLUG, EXPANSION-CYLINDER BLOCK (2"DIA.)
	19-37531		1	PLUG, OIL CHANNEL-CYLINDER BLOCK
4	19-34488		1	PLUG, EXPANSION-CAMSHAFT BEARING HOLE
5	19-34487		1	PLUG, PIPE-CYLINDER BLOCK (3/8")
6	22-36382		1	PLUG, WATER DRAIN-CYLINDER BLOCK
7	23-35168		1	BEARING, DISTRIBUTOR PILOT SHAFT
8	734-3659		AR	PISTON AND PISTON PIN ASSEMBLY (.001 O.S.) USE STANDARD PISTON RING
	734-3660		AR	PISTON AND PISTON PIN ASSEMBLY (.020 O.S.)
	734-3661		AR	PISTON AND PISTON PIN ASSEMBLY (.030 O.S.)
9	39-52266		1	RING, PISTON-6 SETS (STANDARD)
	39-52267		AR	RING, PISTON-6 SETS (.020 O.S.)
	39-52268		AR	RING, PISTON-6 SETS (.030 O.S.)
10	23-52482		2	BEARING UNIT, CAMSHAFT (FRONT AND REAR)
11	23-52483		2	BEARING UNIT, CAMSHAFT (INTERMEDIATE)
12	23-52256		6	BEARING UNIT, CRANKSHAFT MAIN (STANDARD)
	23-52257		AR	BEARING UNIT, CRANKSHAFT MAIN (.001 U.S.)
	23-52258		AR	BEARING UNIT, CRANKSHAFT MAIN (.002 U.S.)
	23-52259		AR	BEARING UNIT, CRANKSHAFT MAIN (.010 U.S.)
	23-52260		AR	BEARING UNIT, CRANKSHAFT MAIN (.020 U.S.)
13	23-52261		1	BEARING UNIT, CRANKSHAFT MAIN-REAR (STANDARD)
	23-52262		AR	BEARING UNIT, CRANKSHAFT MAIN-REAR (.001 U.S.)
	23-52263		AR	BEARING UNIT, CRANKSHAFT MAIN-REAR (.002 U.S.)
	23-52264		AR	BEARING UNIT, CRANKSHAFT MAIN-REAR (.010 U.S.)
	23-52265		AR	BEARING UNIT, CRANKSHAFT MAIN-REAR (.020 U.S.)
14	49954		1	CAP, REAR-CRANKSHAFT BEARING
15	35310		6	CAP, INTERMEDIATE AND FRONT-CRANKSHAFT BEARING
16	10-46717		13	BOLT, CRANKSHAFT BEARING CAP TO CYLINDER BLOCK
17	26-49947		1	OIL SEAL UNIT, CRANKSHAFT REAR BEARING
	34543		1	VALVE, BY-PASS-OIL FILTER
18	222-3657		1	FLYWHEEL, CRANKSHAFT
19	16-52410		6	STUD, FLYWHEEL TO ENGINE COUPLING (2 1/16")
20	52101A1		1	ENGINE COUPLING ASSEMBLY
21	12-30119		6	WASHER, FLYWHEEL STUD
22	11-52163		6	NUT, FLYWHEEL STUD
23	613-3662		6	CONNECTING ROD ASSEMBLING
24	10-52269		12	BOLT, CONNECTING ROD
25	11-37493		12	NUT, CONNECTING ROD CAP BOLT
26	23-52270		6	BEARING (PAIR), CONNECTING ROD (STANDARD)
	23-52271		AR	BEARING (PAIR), CONNECTING ROD (.001 U.S.)

CONTINUED ON NEXT PAGE ➡

CYLINDER BLOCK, PISTON AND CRANKSHAFT

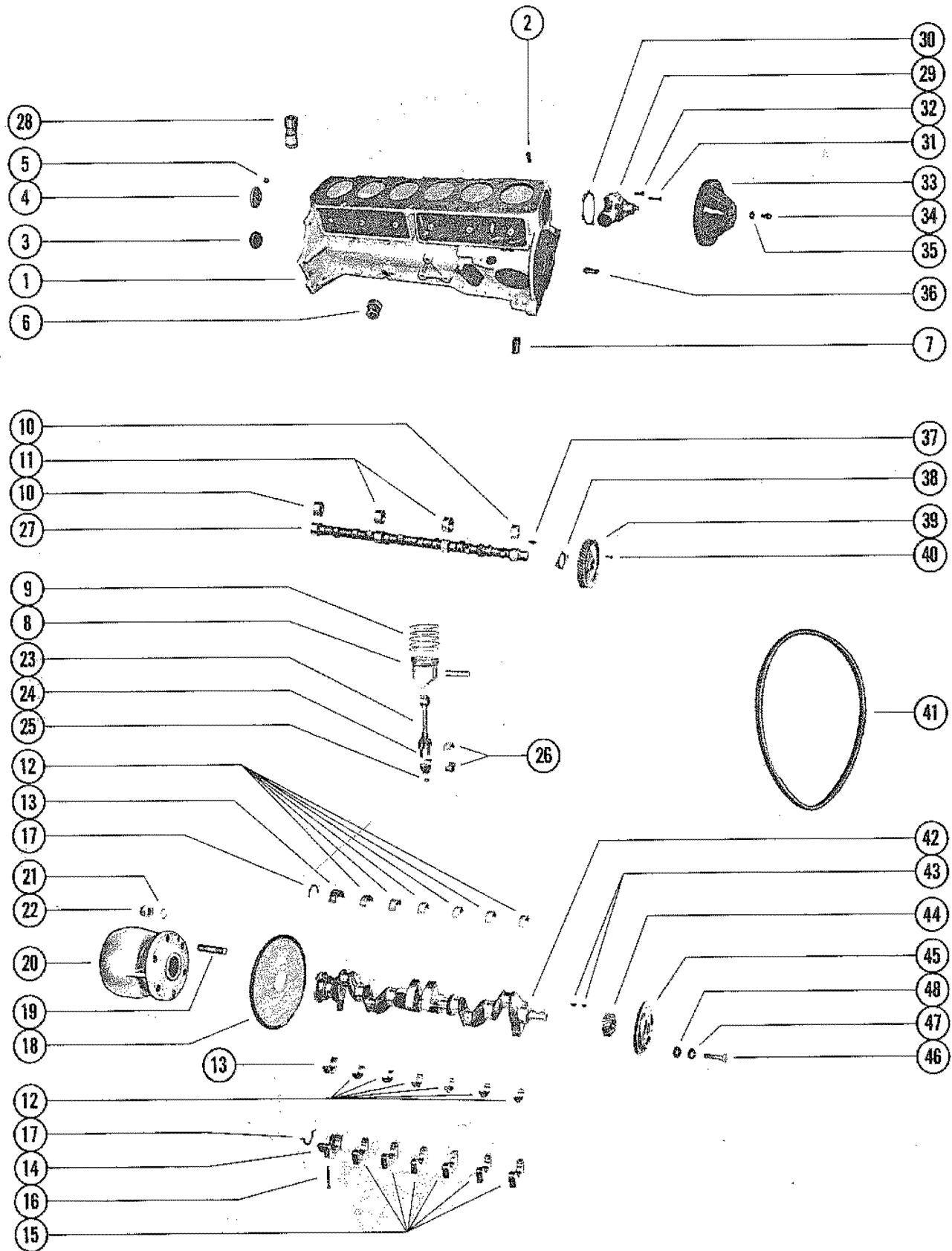

CYLINDER BLOCK, PISTON AND CRANKSHAFT

REF. NO.	PART NO.	SYM.	QTY.	DESCRIPTION
26	23-52272		AR	BEARING (PAIR), CONNECTING ROD (.002 U.S.)
	23-52273		AR	BEARING (PAIR), CONNECTING ROD (.010 U.S.)
	23-52274		AR	BEARING (PAIR), CONNECTING ROD (.020 U.S.)
27	430-3663		1	CAMSHAFT
28	46744		12	LIFTER, VALVE-TAPPET
29	52275		1	WATER PUMP ASSEMBLY (SPECIAL MARINE) SERIAL 00000000-02494935
	54526		1	WATER PUMP ASSEMBLY (SPECIAL MARINE) SERIAL 02494936-09999999
30	27-52248		1	GASKET, WATER PUMP
31	10-34471		2	SCREW, WATER PUMP TO CYLINDER BLOCK (1 1/2")
32	10-35339		1	SCREW, WATER PUMP TO CYLINDER BLOCK (3/4")
	10-34505		1	SCREW, WATER PUMP TO CYLINDER BLOCK (7/8")
33	39972		1	PULLEY, WATER PUMP SERIAL 00000000-00249435
	54525		1	PULLEY, WATER PUMP SERIAL 02494936-09999999
34	10-47277		4	SCREW, PULLEY TO WATER PUMP (3/4")
35	13-39107		4	LOCKWASHER, PULLEY SCREW
36	32-46471		1	NOZZLE, OIL-TIMING GEAR
37	28-34466		1	KEY, CAMSHAFT TIMING GEAR
38	23-34469		1	BEARING, CAMSHAFT THRUST
39	43-46745		1	GEAR, TIMING-CAMSHAFT
40	10-34277		2	SCREW, TIMING GEAR TO CAMSHAFT (1/4")
41	57-32850		1	BELT, ALTERNATOR, WATER PUMP PULLEY AND CRANKSHAFT PULLEY
42	425-3656		1	CRANKSHAFT
43	28-34466		1	KEY, PULLEY AND GEAR LOCATING
44	43-46743		1	GEAR, CRANKSHAFT
45	39973		1	BALANCER, HARMONIC-CRANKSHAFT
46	10-52251		1	BOLT, HARMONIC BALANCER TO CRANKSHAFT
47	13-39131		1	LOCKWASHER, HARMONIC BALANCER BOLT
48	12-35332		1	WASHER, HARMONIC BALANCER BOLT

CYLINDER HEAD AND OIL PAN

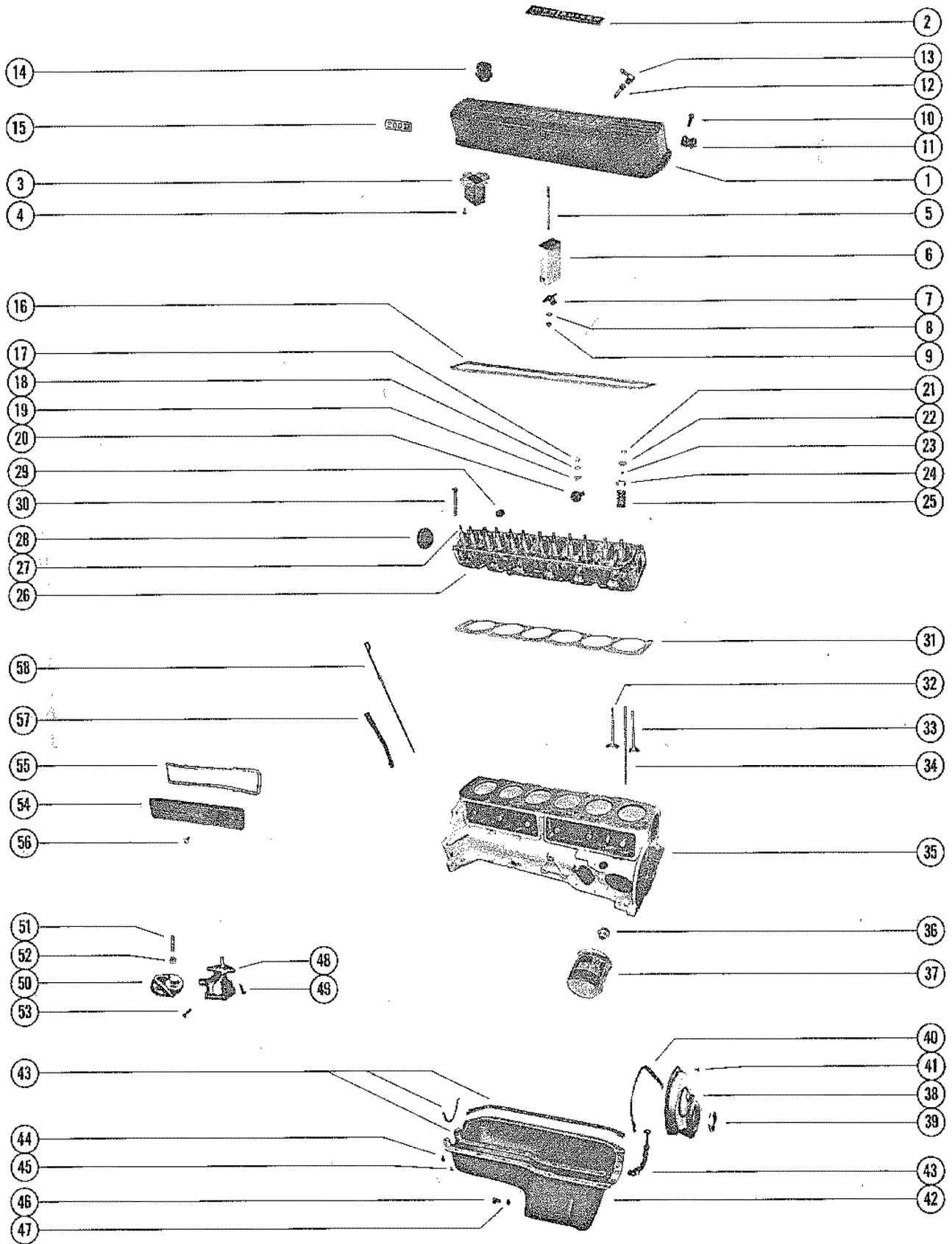

CYLINDER HEAD AND OIL PAN

REF. NO.	PART NO.	SYM.	QTY.	DESCRIPTION
1	39425A3		1	COVER ASSEMBLY, ROCKER
2	37-32852		1	DECAL, ROCKER COVER
3	39785		1	BAFFLE, ROCKER COVER
4	10-30663		4	SCREW, BAFFLE TO ROCKER COVER(3/8")
5	16-45969		1	STUD, BREATHER CHIMNEY TO ROCKER COVER (3 5/16")
6	45369		1	CHIMNEY, BREATHER
7	54-35861		1	CLIP,ROCKER COVER CHIMNEY STUD
8	12-29245		1	WASHER, ROCKER COVER CHIMNEY STUD
9	11-20586		1	NUT, ROCKER COVER CHIMNEY STUD
10	10-35585		7	SCREW, ROCKER COVER TO CYLINDER HEAD (5/8")
11	54-33361		2	CLIP, WIRING HARNESS-ROCKER COVER SCREW
12	22-52669		1	CONNECTOR, VENT-ROCKER COVER
13	22-46131		1	CONNECTOR, VENT HOSE TO CONNECTOR
14	32721		1	OIL FILLER CAP ASSEMBLY, ROCKER COVER
15	37-52467		1	DECAL, ROCKER COVER-"200 H.P."
16	27-49936		1	GASKET, ROCKER COVER
17	11-34516		12	NUT, VALVE ROCKER ARM STUD
18	34517		12	BALL UNIT, VALVE ROCKER ARM STUD
19	35328		6	ROTATOIR ASSEMBLY, EXHAUST VALVE
20	34519		12	ARM, ROCKER
21	28-34514		12	KEY, VALVE STEM (2 PER VALVE)
22	34515		12	CAP, VALVE STEM
23	26-34217		12	SEAL, VALVE SPRING CAP
24	34518		12	SHIELD, VALVE SPRING CAP
25	24-35214		12	SPRING, VALVE
26	937-3040		1	CYLLINDER HEAD ASSEMBLY
27	16-34521		AR	STUD, VALVE ROCKER ARM (.013 O.S.)
	16-34522		AR	STUD, VALVE ROCKER ARM (.003 O.S.)
28	19-34272		3	PLUG, EXPANSION-CYLINDER HEAD (15/16" DIA.)
29	22-48336		2	PLUG, CYLINDER HEAD
30	10-34510		14	BOLT,CYLINDER HEAD TO CYLINDER BLOCK (3 37/64")
31	27-47453		1	GASKET, CYLINDER HEAD
32	34528		6	VALVE, EXHAUST (STANDARD STEM) SERIAL 00000000-02494935
	52360		6	VALVE, EXHAUST (STANDARD STEM) SERIAL 02494936-09999999
	34529		AR	VALVE, EXHAUST (.015 O.S. STEM)
33	35319		6	VALVE, INLET 9STANDARD STEM)
	35321		AR	VALVE, INLET (.015 O.S. STEM)
34	52253		12	ROD, PUSH-VALVE
35	840-3658		1	CYLINDER BLOCK ASSEMBLY SEE B6 FOR BREAKDOWN
36	32720		1	CONNECTOR, OIL FILTER TO CYLINDER BLOCK
37	52731		1	OIL FILTER ASSEMBLY
38	49951		1	COVER ASSEMBLY, CRANKCASE

CONTINUED ON NEXT PAGE ➡

CYLINDER HEAD AND OIL PAN

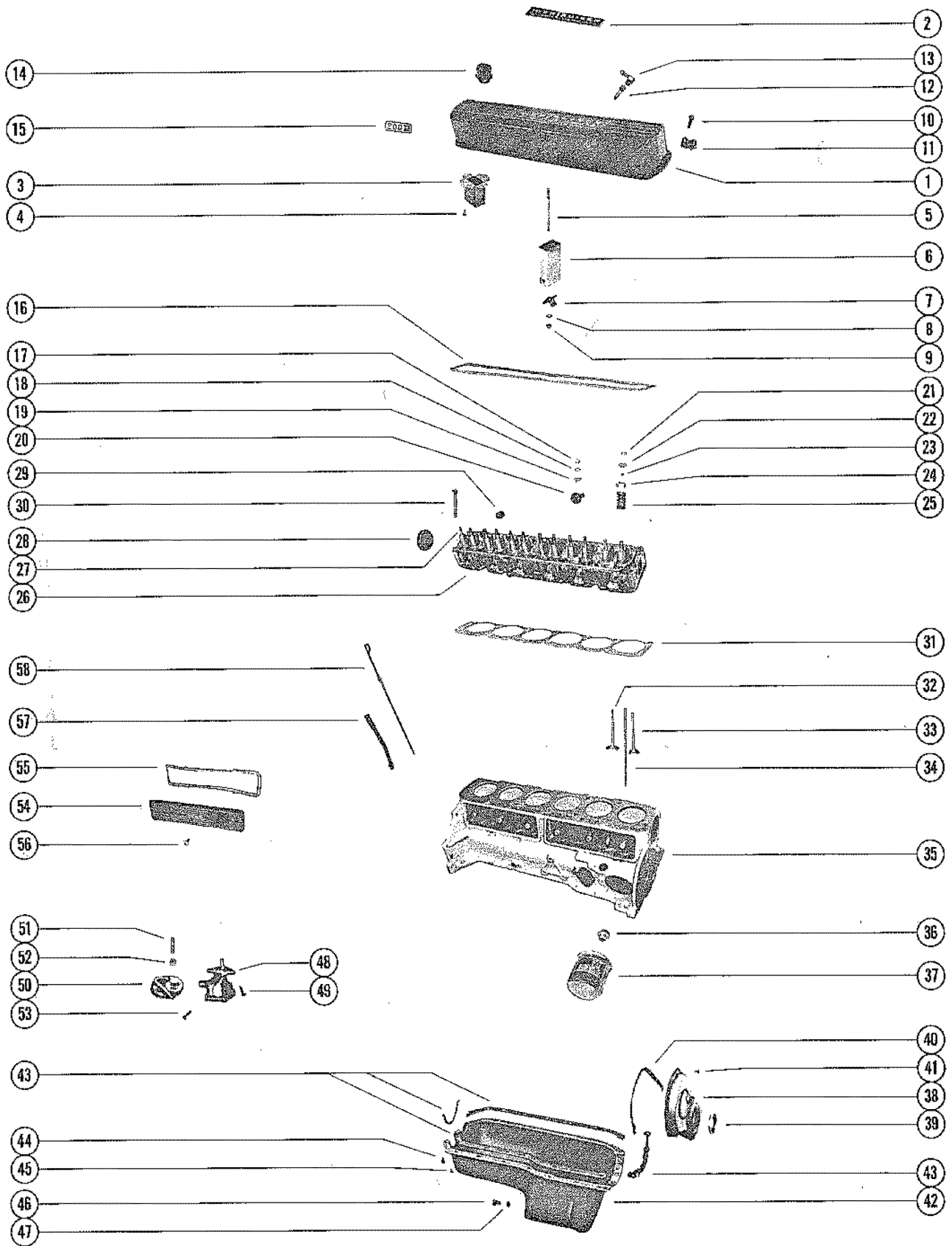

CYLINDER HEAD AND OIL PAN

REF. NO.	PART NO.	SYM.	QTY.	DESCRIPTION
39	26-49952		1	OIL SEAL, CRANKCASE COVER
40	27-49953		1	GASKET, CRANKCASE COVER
41	10-34277		8	SCREW, CRANKCASE COVER TO CYLINDER BLOCK (7/16")
42	52252		1	OIL PAN ASSEMBLY
43	27-49949		1	GASKET SET, OIL PAN
44	10-34500		4	SCREW, OIL PAN TRO CYLINDER BLOCK (5/16")
45	10-34277		20	SCREW, OIL PAN TO CYLINDER BLOCK (1/4")
46	10-49956		1	SCREW, DRAIN-OIL PAN
47	27-49955		1	GASKET, OIL PAN DRAIN SCREW
48	36405		1	OIL PUMP ASSEMBLY
	27-34460		1	GASKET, OIL PUMP COVER
49	10-35339		2	SCREW, OPIL PUMP TO CYLINDER BLOCK (3/4")
50	52276		1	SCREEN ASSEMBLY, OIL PUM,P
51	16-39729		1	STUD, OIL PUMP SCREEN SUPPOT TO BEARING CAP (3 3/4")- PART OFCYLINDER BLOCK ASSEMBLY
52	11-37500		1	NUT, BEARING CAP STUD-OIL PUMP SCREEN BRACKET
53	10-35366		1	BOLT, OIL PUMP SCREEN TO MOUNTING BRACKET (1/2")
54	52254		2	COVER, CRANKCASE AND PUSH ROD
55	27-52255		2	GASKET, CRANKCASE AND PUSH ROD COVER
56	10-34470		6	SCREW, CRANKCASE AND PUSH ROD COVER TO CYLINDER BLOCK (5/8")
57	48403		1	TUBE, OIL LEVEL GAUGE SERIAL 00000000-02494935
	32-53391		1	TUBE, OIL LEVEL GUAGE SERIAL 02494936-09999999
58	52249		1	GUAGE, OIL LEVEL (DIP STICK)

EXHAUST KIT

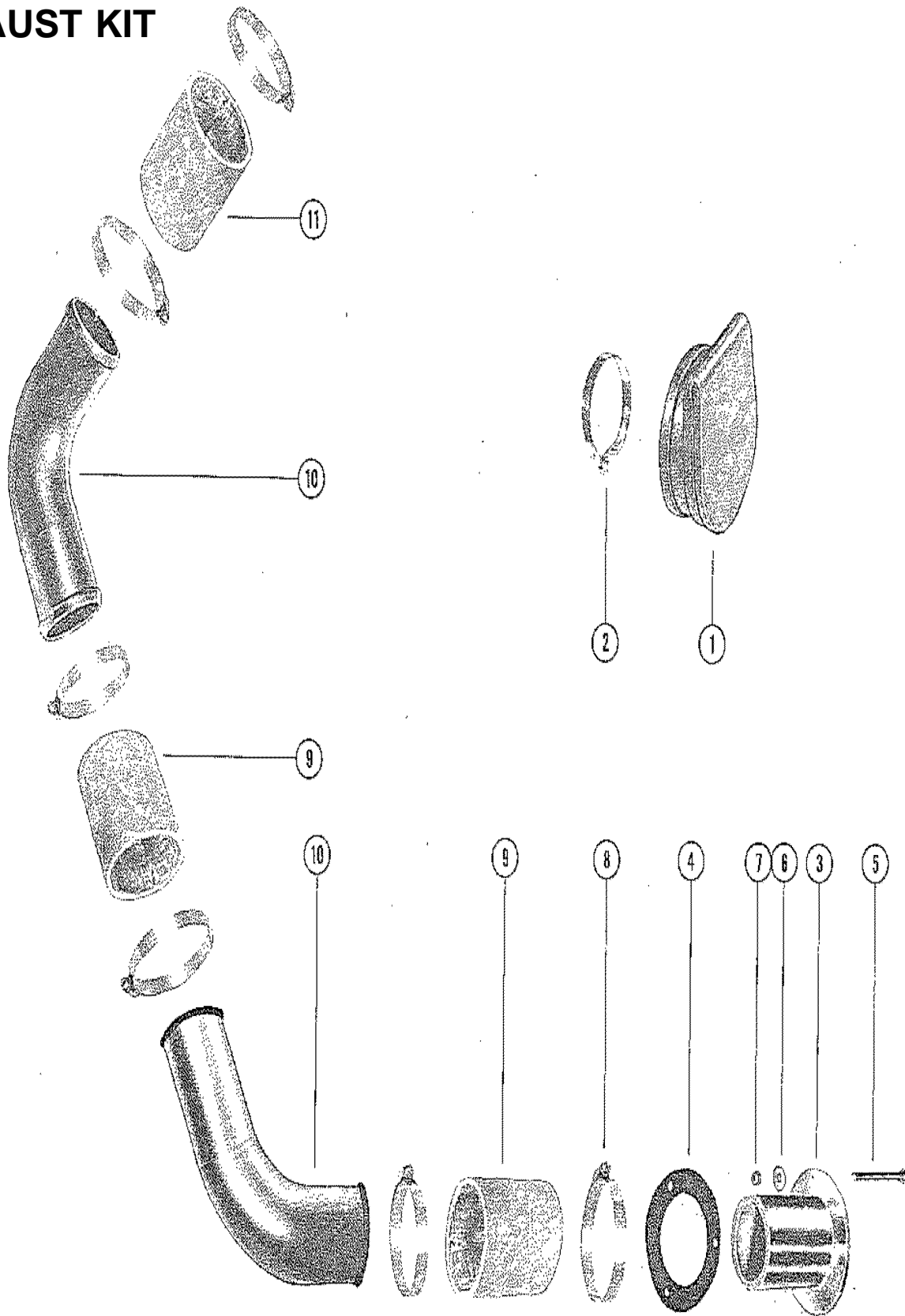

EXHAUST KIT

REF. NO.	PART NO.	SYM.	QTY.	DESCRIPTION
-	52637A1		1	EXHAUST KIT
1	34765A1		1	COVERKIT, EXHAUST FLANGE
2	54-33683		2	CLAMP, COVER TO FLANGE
3	35013		1	FLANGE, EXHAUST HOSE
4	27-33600		1	GASKET, EXHAUST HOSE FLANGE
5	10-33684		3	SCREW, HOSE FLANGE TO BOAT
6	12-25908		3	WASHER, EHAUST HOSE FLANGE TO BOAT SCREW
7	11-20361		3	NUT, EXHAUST HOSE FLANGE TO BOAT SCREW
8	54-33683		12	CLAMP,EXHAUST HOSE ATTACHING
9	32-48659--1		2	HOSE, EXHAUST (4")
10	52637		2	ELBOW, EXHAUST
11	32-48659--2		1	HOSE, EXHAUST (5 1/4")

PARTS INDEX

Part Number	Description	Pg.	Ref. No.	Part Number	Description	Pg.	Ref. No.
22789	"D" WASHER, WIRING HARNESS CLAMP SCREW	21	12	33668	HOUSING, PRIMARY - DISTRIBUTOR	7	2
22789	"D" WASHER, WIRING HARNESS CLIP SCREW	3	10	33670	RETAINER, BREAKER CAM ADVANCE	7	6
22789	"D" WASHER, WIRING HARNESS CLIP SCREW	3	7	33765	CAP, DISTRIBUTOR	7	21
22789	"D" WASHER, WIRING HARNESS SCREW	25	14	34235	BREAKER ASSEMBLY, DISTRIBUTOR	7	15
25661	STARTER SOLENOID	3	11	34480	CLAMP UNIT, DISTRIBUTOR	9	43
26079	PLATE, WIRING HARNESS TO MOUNTING BRACKET	3	3	34515	CAP, VALVE STEM	35	22
26433	COIL ASSEMBLY, IGNITION	7	35	34517	BALL UNIT, VALVE ROCKER ARM STUD	35	18
26551	TAB, RETAINER RETURN SPRING	13	38	34518	SHIELD, VALVE SPRING CAP	35	24
27947	SWIVEL, LINK ROD TO THROTTLE LEVER	13	39	34519	ARM, ROCKER	35	20
32720	CONNECTOR, OIL FILTER TO CYLINDER BLOCK	35	36	34528	VALVE, EXHAUST (STANDARD STEM)	35	32
32721	OIL FILLER CAP ASSEMBLY, ROCKER COVER	35	14	34529	VALVE, EXHAUST (.015 O.S. STEM)	35	32
32762A1	LEAD ASSEMBLY, HIGH TENSION - DISTRIBUTOR (6 1/4")	7	26	34543	VALVE, BY-PASS-OIL FILTER	31	17
32762A2	LEAD ASSEMBLY, HIGH TENSION - DISTRIBUTOR (14 1/4")	7	27	34549	RETAINER, DISTRIBUTOR CLAMP UNIT	9	44
32762A3	LEAD ASSEMBLY, HIGH TENSION - DISTRIBUTOR (20 3/4")	7	28	34623	OIL PRESSURE SENDER ASSEMBLY	3	19
32762A4	LEAD ASSEMBLY, HIGH TENSION - DISTRIBUTOR (22")	7	29	34765A1	COVERKIT, EXHAUST FLANGE	39	1
32763A1	WIRE ASSEMBLY, DISTRIBUTOR TO COIL (8 1/4")	7	34	35013	FLANGE, EXHAUST HOSE	39	3
32783	RETAINER, HIGH TENSION LEADS	7	33	35310	CAP, INTERMEDIATE AND FRONT-CRANKSHAFT BEARING	31	15
32784	RETAINER, HIGH TENSION LEADS	7	32	35319	VALVE, INLET 9STANDARD STEM)	35	33
32877	COVER, WATER PUMP (1 1/16"LONG)	23	41	35321	VALVE, INLET (.015 O.S. STEM)	35	33
33210	JUMPER WIRE, BALLAST TO BALLAST	9	46	35328	ROTATOIR ASSEMBLY, EXHAUST VALVE	35	19
33321	BRACKET, IGNITION COIL MOUNTING	7	36	35852	MOUNT, RUBBER-FLYWHEEL HOUSING	25	2
33393	SLEEVE, ADJUSTING - THROTTLE LINK ROD	13	41	35864	COVER PLATE, FLYWHEEL HOUSING	25	3
33394	LINK ROD, CARBURETOR	13	43	36405	OIL PUMP ASSEMBLY	37	48
33651	WEIGHT, BREAKER CAM ADVANCE	7	7	36525	WATER TEMPERATURE SENDER ASSEMBLY	3	24
33653	FELT, BREAKER CAM LUBRICATOR	7	6	37615A1	ALTERNATOR ASSEMBLY	5	11
33654	BUTTON, CARBON - DISTRIBUTOR CAP	7	22	37707	VOLTAGE REGUALTOR, TRANSISTORIZED	3	28
33655	PLATE, WEIGHT HOLD DOWN	7	9	38979	LEVER, THROTTLE - MOUNTING BRACKET	11	30
33659	ROTOR, DISTRIBUTOR	7	19	38983	SWIVEL, LINK ROD TO CARBURETOR	13	44
33662	CONDENSER	7	13	39425A3	COVER ASSEMBLY, ROCKER	35	1
				39785	BAFFLE, ROCKER COVER	35	3
				39972	PULLEY, WATER PUMP	33	33
				39973	BALANCER, HARMONIC-CRANKSHAFT	33	45
				39974	CONNECTOR, HARNESS LEADS TO FLYWHEEL HOUSING	25	15
				39995	BRACE, ALTERNATOR TO CYLINDER BLOCK	5	12

PARTS INDEX

Part Number	Description	Pg.	Ref. No.	Part Number	Description	Pg.	Ref. No.
39998	BRACKET, ALTERNATOR MOUNTING	5	22	52078	BRACKET, MOUNTING (FRONT-STARBOARD SIDE)	27	8
45107	BATTERY CABLE, NEGATIVE LUG TYPE	3	2	52081	LINK ROD, THROTTLE	13	40
45108	BATTERY CABLE, POSITIVE LUG TYPE	3	2	52091	PLATE, TUNING	13	57
45369	CHIMNEY, BREATHER	35	6	52101A1	ENGINE COUPLING ASSEMBLY	31	20
46265	BOOT, SOLENOID TERMINAL	3	16	52124	BRACKET, MOUNTING - THROTTLE LINKAGE	11	21
46744	LIFTER, VALVE-TAPPET	33	28	52134	BRACKET, MOUNTING (FRONT-PORT SIDE)	27	1
47403	SHAFT AND BEARING	29	6	52139A2	BRACKET ASSEMBLY, MOUNTING	27	17
47405	WEAR PLATE	29	12	52139A4	BRACKET ASSEMBLY, MOUNTING	27	17
47497A1	COVER ASSEMBLY, WATER PUMP	29	16	52249	GUAGE, OIL LEVEL (DIP STICK)	37	58
47518	TRUNNION, ADJUSTING-MOUNTING BRACKET	27	24	52250	BRACE, STARTER MOTOR	5	7
47529	INSERT, WATER PUMP BODY	29	13	52252	OIL PAN ASSEMBLY	37	42
47530	HUB, WATER PUMP PULLEY	29	3	52253	ROD, PUSH-VALVE	35	34
47585	FUEL PUMP ASSEMBLY (NOT AS SHOWN)	11	1	52254	COVER, CRANKCASE AND PUSH ROD	37	54
47587A2	BLOCK ASSEMBLY, WATER DISTRIBUTION-CYLINDER BLOCK	21	31	52275	WATER PUMP ASSEMBLY (SPECIAL MARINE)	33	29
47588	COVER, THERMOSTAT-WATER DISTRIBUTION BLOCK	21	35	52276	SCREEN ASSEMBLY, OIL PUM,P	37	50
47594	THERMOSTAT	21	37	52277	DISTRIBUTOR ASSEMBLY, COMPLETE	7	1
47604A1	PROTECTOR, HIGH TENSION LEAD	7	30	52278	MAIN SHAFT AND WEIGHT PLATE	7	4
47656	MOUNT, MOUNTING BRACKET	27	18	52279	CAM, BREAKER - ADVANCE	7	6
47834	FLAME ARRESTOR, CARBURETOR (NOT AS SHOWN)	13	58	52360	VALVE, EXHAUST (STANDARD STEM)	35	32
47986	BRACKET, MOUNTING-ENGINE	27	16	52392	TAB, RETAINER - THROTTLE RETURN SPRING	13	38
48024	BRACKET, CONDENSER MOUNTING	7	13	52470	LEVER, THROTTLE - CARBURETOR	13	50
48025	LEAD, PRIMARY	7	18	52636	WIRING HARNESS, EXTERNAL	3	1
48044	END CAP/CONNECTOR, EXHAUST MANIFOLD (FRONT)	21	24	52637	ELBOW, EXHAUST	39	10
48045	END CAP, EXHAUST MANIFORD (REAR)	21	13	52637A1	EXHAUST KIT	39	-
48315A4	PLUNGER AND LINK ASSEMBLY, CHOKE SOLENOID	15	68	52667	CHOKE SOLENOID	15	71
48403	TUBE, OIL LEVEL GAUGE	37	57	52676	SWITCH, THERMAL - CHOKE	3	25
49089	DIAPHRAGM KIT, FUEL PUMP	11	3	52726	BRACKET, MOUNTING - CHOKE SOLENOID	15	74
49581	BRACKET, WATER PUMP	29	33	52729	TAB, RETAINER - CHOKE RETURN SPRING	15	66
49587	BRACE, WATER PUMP ADJUSTING	29	26	52730	LEVER, CHOKE - CARBURETOR	13	52
49951	COVER ASSEMBLY, CRANKCASE	35	38	52731	OIL FILTER ASSEMBLY	35	37
49954	CAP, REAR-CRANKSHAFT BEARING	31	14	52753	MOUNT, MOUNTING BRACKET	27	18
49964A1	EHAUST ELBOW ASSEMBLY	21	17	52754	HOUSING, FLYWHEEL	25	1
				52811	TIE BAR, FRONT MOUNT CONNECTING	27	2
				52822	PULLEY, WATER PUMP	29	2
				53652A1	HOUSING ASSEMBLY, FLYWHEEL	25	1
				54216	LEVER, THROTTLE - CARBURETOR	13	50

PARTS INDEX

Part Number	Description	Pg.	Ref. No.	Part Number	Description	Pg.	Ref. No.
54218	LINK ROD, THROTTLE	13	40	10-28063	SCREW, STARTER SOLENOID TO FLYWHEEL HOUSING (5/8")	3	12
54525	PULLEY, WATER PUMP . . .	33	33				
54526	WATER PUMP ASSEMBLY (SPECIAL MARINE)	33	29	10-28635	SCREW, WATER PUMP COVER TO WATER PUMP BODY (5/8")	29	19
54684	COVER, WATER PUMP (1 3/8"LONG)	23	41				
10-20031	SCREW, BALLAST TO FLYWHEEL HOUSING (1/2")	9	50	10-29198	SCREW, ALTERNATOR BRACE TO ALTERNATOR (7/8")	5	15
10-20314	SCREW, DRIVE- SERIAL PLATE TO CYLINDER BLOCK (3/16")	25	21	10-29199	SCREW, FUEL LINE CLAMP FASTENING (1")	11	15
10-20362	SCREW, CARBURETOR TO EXHAUST MANIFOLD (1 1/2")	13	63	10-30268	SCREW, CLAMP TO MANIFOLD	3	9
10-20705	SCREW, WATER PUMP PULLEY TO WATER PUMP (3/4")	29	4	10-30663	SCREW, BAFFLE TO ROCKER COVER(3/8") . . .	35	4
10-20776	SCREW, WIRING HARNESS RETAINING CLIP	21	28	10-31381	SCREW, ADJUSTING BRACE TO CYLINDER BLOCK (1")	29	27
10-21077	SCREW, WATER DISTRIBUTION BLOCK TO CYLINDER HEAD (7/8") . .	21	33	10-31984	BOLT, MOUNTING BRACKET TO EXHAUST MANIFOLD (1 1/4")	11	28
10-21625	SCREW, CHOKE SOLENOID TO MOUNTING BRACKET (3/4")	15	75	10-32775	SCREW, ALTERNATOR TO BRACKET (3 1/2")	5	17
10-22028	SCREW, WIRING HARNESS CLAMP FASTENING (1/2")	21	10	10-33311	SCREW, MOUNTING BRACKET TO IGNITION COIL	7	37
10-22245	SCREW, WIRING HARNESS CLAMP ATTACHING (1/2")	25	12	10-33648	SCREW, MOUNTING PLATE TO PRIMARY HOUSING (3/8")	7	12
10-22793	SCREW, WOOD - WIRING HARNESS CLIP TO BOAT (7/8"0	3	6	10-33650	SCREW, BREAKER ASSEMBLY TO MOUNTING PLATE (5/32")	7	16
10-25038	SCREW, END CAP TO EXHAUST MANIFOLD (7/8")	21	15	10-33656	SCREW, WEIGHT HOLD DOWN PLATE TO WEIGHT PLATE	7	10
10-25038	SCREW, END CAP/CONNECTOR TO EXHAUST MANIFOLD (7/8")	21	26	10-33660	SCREW, DISTRIBUTOR CAP TO PRIMARY HOUSING (8-32)	7	23
10-25299	SCREW, COVER PLATE TO FLYWHEEL HOUSING (3/4")	25	4	10-33663	SCREW, DISTRIBUTOR CAP TO PRIMARY HOUSING (10-32)	7	24
10-25703	SCREW, FUEL LINE CLAMP FASTENING (1/2")	11	19	10-33684	SCREW, HOSE FLANGE TO BOAT	39	5
10-26632	SCREW, ADJUSTING BRACE TO WATER PUMP BRACKET (1 1/4")	29	29	10-34277	SCREW, CRANKCASE COVER TO CYLINDER BLOCK (7/16")	37	41
10-26632	SCREW, ALTERNATOR BRACKET TO CYLINDER BLOCK (1 1/4")	5	23	10-34277	SCREW, OIL PAN TO CYLINDER BLOCK (1/4") . .	37	45
10-27165	SCREW, HOSE CLIP TO EXHAUST MANIFOLD . . .	29	23	10-34277	SCREW, TIMING GEAR TO CAMSHAFT (1/4")	33	40
10-27165	SCREW, IGNITION COIL TO CYLINDER BLOCK (3/4") . .	9	40	10-34354	SCREW, WATER PUMP BRACKET CLAMPING (1 1/2")	29	34
10-27165	SCREW, LIFTING EYE TO CYLINDER BLOCK (3/4") . .	25	18	10-34370	SCREW, AIR HORN TO FLOAT BOWL (1")	17	7
10-27379	SCREW, CHOKE LEVER TO CARBURETOR (3/8")	13	53	10-34470	SCREW, CRANKCASE AND PUSH ROD COVER TO CYLINDER BLOCK (5/8") . .	37	56
				10-34471	SCREW, WATER PUMP TO CYLINDER BLOCK (1 1/2")	33	31

PARTS INDEX

Part Number	Description	Pg.	Ref. No.	Part Number	Description	Pg.	Ref. No.
10-34505	SCREW, WATER PUMP TO CYLINDER BLOCK (7/8")	33	32	10-48144	SCREW, IDLE STOP	19	43
10-34510	BOLT, CYLINDER HEAD TO CYLINDER BLOCK (3 37/64")	35	30	10-48145	SCREW, THROTTLE BODY TO FLOAT BOWL	19	55
10-34544	BOLT, STARTER MOTOR MOUNTING 91 27/32")	5	3	10-48146	SCREW, LEVER AND CAM TO THROTTLE BODY	19	58
10-34545	BOLT, STARTER MOTOR MOUNTING (4 21/32")	5	2	10-48254	SCREW, MOUNTING BRACKET ATTACHING (2 1/8")	27	20
10-35169	SCREW, DISTRIBUTOR TO CYLINDER BLOCK (1")	9	42	10-48395	SCREW, AIR HORN TO FLOAT BOWL (3")	17	8
10-35339	SCREW, OIL PUMP TO CYLINDER BLOCK (3/4")	37	49	10-48424	SCREW, HOUSING TO BLOCK (1 5/8")	25	7
10-35339	SCREW, WATER PUMP TO CYLINDER BLOCK (3/4")	33	32	10-49956	SCREW, DRAIN-OIL PAN	37	46
10-35366	BOLT, OIL PUMP SCREEN TO MOUNTING BRACKET (1/2")	37	53	10-52143	SCREW, EXHAUST MANIFOLD TO CYLINDER HEAD (4 3/4")	21	7
10-35585	SCREW, BALLAST TO FLYWHEEL HOUSING (3/4")	9	50	10-52156	SCREW ADJUSTING TRUNNION (4 1/2")	27	22
10-35585	SCREW, ROCKER COVER TO CYLINDER HEAD (5/8")	35	10	10-52251	BOLT, HARMONIC BALANCER TO CRANKSHAFT	33	46
10-37892	SCREW, CONNECTOR TO FLYWHEEL HOUSING (7/8")	25	16	10-52269	BOLT, CONNECTING ROD	31	24
10-37908	SCREW, VOLTAGE REGULATOR TO TRANSOM (1 1/4")	3	29	10-52409	SCREW, WATER PUMP BRACKET T ALTERNATOR BRACKET (3 1/4")	29	36
10-38507	SCREW, STEP - THROTTLE LEVER TO MOUNTING BRACKET	11	34	10-52447	BOLT, MOUNTING BRACKET TO EXHAUST MANIFOLD (2 1/4")	11	25
10-38837	SCREW, ALTERNATOR BRACE TO CYLINDER BLOCK (1 1/8")	5	13	10-52909	SCREW, CARBURETOR TO EXHAUST MANIFOLD (4 3/4")	13	62
10-45488	SCREW, FUEL PUMP TO CYLINDER BLOCK (3/4")	11	5	10-53044	SCREW, HOUSING TO BLOCK (2 1/4")	25	8
10-46717	BOLT, CRANKSHAFT BEARING CAP TO CYLINDER BLOCK	31	16	10-53512	SCREW, THERMOSTAT COVER TO WATER DISTRIBUTION BLOCK (3/4")	21	38
10-46718	SCREW, WIRING HARNESS LEADS TO BALLAST (3/4")	9	47	10-53734	SCREW, HOUSING TO BLOCK (3")	25	6
10-46718	SCREW, WIRING HARNESS PLATE TO MOUNTING BRACKET (3/4")	3	4	11-20083	NUT, STARTER SOLENOID TERMINAL (5/16")	3	15
10-47277	SCREW, PULLEY TO WATER PUMP (3/4")	33	34	11-20110	NUT, LINK ROD TO CARBURETOR SWIVEL	13	46
10-47654	SCREW, CLAMP-ADJUSTING TRUNNION (2 3/4")	27	12	11-20110	NUT, THROTTLE LEVER STUD	11	33
10-48021	SCREW, CONDENSER BRACKET ATTACHING	7	14	11-20361	NUT, EXHAUST HOSE FLANGE TO BOAT SCREW	39	7
10-48115	SCREW, HOUSING TO BLOCK (3 1/2")	25	6	11-20586	NUT, FLAME ARRESTOR MOUNTING STUD (TOP)	13	60
10-48137	SCREW, AIR HORN TO FLOAT BOWL (3/8")	17	6	11-20586	NUT, ROCKER COVER CHIMNEY STUD	35	9
10-48138	SCREW, VACUUM CONTROL BRACKET TO FLOAT BOWL	17	32	11-20586	NUT, THROTTLE CABLE ANCHOR STUD	11	24
10-48139	SCREW, CHOKE VALVE TO CHOKE SHAFT	17	21	11-20645	NUT, CHOKE SOLENOID TERMINAL	15	73
				11-20645	NUT, IGNITION TERMINAL	9	39
				11-20645	NUT, STARTER SOLENOID TERMINAL (10-32)	3	18

PARTS INDEX

Part Number	Description	Pg.	Ref. No.	Part Number	Description	Pg.	Ref. No.
11-20645	NUT, WATER SENDER/OIL PRESSURE SENDER TERMINAL (10-32)	3	23	12-20553	WASHER, THROTTLE LEVER STEP SCREW (3/8" O.D.)	11	36
11-20890	NUT, FUEL LINE CLAMP SCREW	11	17	12-22937	WASHER, FLAME ARRESTOR MOUNTING STUD	13	59
11-21270	NUT, CHOKE LEVER SCREW	13	55	12-24662	WASHER, FUEL LINE CLAMP SCREW	11	16
11-23161	NUT, ALTERNATOR SCREW	5	20	12-24664	WASHER, THROTTLE CABLE ANCHOR STUD	11	23
11-23161	NUT, WATER PUMP BRACKET SCREW	29	38	12-25908	WASHER, EHAUST HOSE FLANGE TO BOAT SCREW	39	6
11-25168	NUT, JAM - THROTTLE LINK ROD	13	42	12-26168	WASHER, ALTERNATOR BRACE SCREW	5	16
11-26419	NUT, SOLENOID SWITCH TERMINAL (8-32)	5	4	12-26825	WASHER, CARBURETOR SCREW	13	64
11-28517	NUT, ADJUSTING BRACE SCREW	29	32	12-28927	WASHER, BALLAST SCREW	9	51
11-28517	NUT, HOSE CLIP SCREW	29	25	12-29245	WASHER, ROCKER COVER CHIMNEY STUD	35	8
11-28517	NUT, HOUSING SCREW	25	10	12-30119	WASHER, FLYWHEEL STUD	31	21
11-28517	NUT, SOLENOID SWITCH TERMINAL (3/8-16)	5	6	12-30164	WASHER, IGNITION COIL TERMINAL	7	38
11-28941	NUT, JAM - FLAME ARRESTOR MOUNTING STUD (BOTTOM)	13	49	12-30164	WASHER, LINK ROD TO CARBURETOR SWIVEL	13	45
11-29553	NUT, CLAMP ADJUSTING TRUNNION SCREW	27	15	12-30164	WASHER, THROTTLE LEVER STUD (3/8" O.D.)	11	32
11-34516	NUT, VALVE ROCKER ARM STUD	35	17	12-30191	WASHER, WIRING HARNESS LEADS SCREW	9	49
11-35814	NUT, STARTER MOTOR BRACE STUD	5	10	12-35332	WASHER, HARMONIC BALANCER BOLT	33	48
11-35888	NUT, CHOKE AND SOLENOID SCREW	15	76	12-35950	WASHER, THROTTLE LEVER STUD (7/16" O.D.)	11	31
11-37493	NUT, CONNECTING ROD CAP BOLT	31	25	12-36275	WASHER, ROTOR	7	20
11-37500	NUT, BEARING CAP STUD-OIL PUMP SCREEN BRACKET	37	52	12-38833	WASHER, PLUNGER AND LINK	15	69
11-46793	NUT, CARBURETOR SCREW (FRONT)	15	65	12-47683	WASHER, SHAFT AND BEARING	29	8
11-47525	NUT, JAM- ADJUSTING TRUNNION SCREW	27	25	12-48611	WASHER, MOUNTING BACKET	27	19
11-49838	NUT, EXHASUT ELBOW MANIFOLD STUD	21	23	12-53510	WASHER, THROTTLE LEVER STEP SCREW (21/64" O.D.)	11	35
11-49838	NUT, MOUNTING BRACKET STUD	27	11	13-26992	LOCKWASHER, STARTER SOLENOID SCREW	3	13
11-49838	NUT, MOUNTING BRACKET STUD	27	7	13-26993	LOCKWASHER, ALTERNATOR BRACE SCREW	5	14
11-52163	NUT, FLYWHEEL STUD	31	22	13-26993	LOCKWASHER, STARTER SOLENOID TERMINAL (5/16")	3	14
11-52829	NUT, TIE BAR FASTENING	27	4	13-26994	LOCKWASHER, CHOKE LEVER SCREW	13	54
12-20028	WASHER, VOLTAGE REGULATOR SCREW	3	30	13-26995	LOCKWASHER, STARTER MOTOR TERMINAL	5	5
12-20103	WASHER, STARTER MOTOR BRACE STUD	5	9	13-26995	LOCKWASHER, WIRING HARNESS LEADS SCREW	9	48
12-20192	WASHER, ALTERNATOR GROUND TERMINAL	5	21	13-26996	LOCKWASHER, CHOKE SOLENOID TERMINAL	15	72
12-20553	WASHER, ADJUSTING BRACE SCREW	29	30	13-26996	LOCKWASHER, IGNITION COIL TERMINAL	9	38
12-20553	WASHER, ALTERNATOR SCREW	5	18				
12-20553	WASHER, EXHAUST MANIFOLD SCREW	21	8				

PARTS INDEX

Part Number	Description	Pg.	Ref. No.	Part Number	Description	Pg.	Ref. No.
13-26996	LOCKWASHER, STARTER SOLENOID TERMINAL (#10)	3	17	16-34521	STUD, VALVE ROCKER ARM (.013 O.S.)	35	27
13-26996	LOCKWASHER, THERMAL SWITCH TERMINAL	3	26	16-34522	STUD, VALVE ROCKER ARM (.003 O.S.)	35	27
13-26996	LOCKWASHER, WIRING HARNESS CLAMP SCREW	21	11	16-38525	STUD, ANCHOR - THROTTLE CABLE TO MOUNTING BRACKET	11	22
13-26996	LOCKWASHER, WIRING HARNESS CLAMP SCREW	25	13	16-39729	STUD, OIL PUMP SCREEN SUPPOT TO BEARING CAP (3 3/4")	37	51
13-26996	WASHER, WATER SENDER/OIL PRESSURE SENDER TERMINAL (#10)	3	22	16-45969	STUD, BREATHER CHIMNEY TO ROCKER COVER (3 5/16")	35	5
13-31848	LOCKWASHER, MOUNTING BRACKET SCREW	27	21	16-49545	STUD, EXHAUST MANIFOLD TO EXHAUST ELBOW (1 3/4")	21	2
13-31848	LOCKWASHER, TIE BAR	27	3	16-52387	STUD, STARTER MOTOR BRACE MOUNTING	5	8
13-32993	LOCKWASHER, ADJUSTING BRACE SCREW	29	28	16-52410	STUD, FLYWHEEL TO ENGINE COUPLING (2 1/16")	31	19
13-32993	LOCKWASHER, CLAMP ADJUSTING TRUNNION SCREW	27	13	16-52605	STUD, MOUNTING BRACKET TO CYLINDER BLOCK (2")	27	5
13-35048	LOCKWASHER, ADJUSTING BRACE SCREW	29	31	16-52605	STUD, MOUNTING BRACKET TO CYLINDER BLOCK (2")	27	9
13-35048	LOCKWASHER, HOSE CLIP SCREW	29	24	16-52606	STUD, MOUNTING BRACKET TO CYLINDER BLOCK (2 3/4")	27	5
13-35048	LOCKWASHER, WATER PUMP BRACKET CLAMPING SCREW	29	35	17-22116	PIN, ROLL-JAM NUT	27	26
13-37459	LOCKWASHER, ALTERNATOR MOUNTING BRACKET SCREW	5	24	17-33649	PIN, DRIVE GEAR TO MAIN SHAFT	7	5
13-37459	LOCKWASHER, EXHAUST ELBOW TO EXHASUT MANIFOLD STUD	21	22	17-35465	PIN, DOWEL-CYLINDER BLOCK TO CYLINDER HEAD	31	2
13-37459	LOCKWASHER, FUEL LINE CLAMP SCREW	11	20	17-47526	PIN, IMPELLER DRIVE	29	15
13-37459	LOCKWASHER, HOUSING SCREW	25	9	17-48140	PIN, HINGE - FLOAT	17	23
13-37459	LOCKWASHER, MOUINTING BRACKET STUD	27	6	17-49489	RIVET, THROTTLE LEVER TO CARBURETOR	13	51
13-37459	LOCKWASHER, MOUNTING BRACKET STUD	27	10	18-26953	COTTER PIN, PLUNGER AND LINK TO CHOKE LEVER	15	70
13-37459	WASHER, LIFTING EYE SCREW	25	19	19-34270	PLUG, EXPANSION-CYLINDER BLOCK (1 5/8"DIA.)	31	3
13-39107	LOCKWASHER, COVER PLATE SCREW	25	5	19-34271	PLUG, EXPANSION-CYLINDER BLOCK (2"DIA.)	31	3
13-39107	LOCKWASHER, MOUNTING BRACKET BOLT	11	26	19-34272	PLUG, EXPANSION-CYLINDER HEAD (15/16" DIA.)	35	28
13-39107	LOCKWASHER, PULLEY SCREW	33	35	19-34487	PLUG, PIPE-CYLINDER BLOCK (3/8")	31	5
13-39107	LOCKWASHER, WATER PUMP PULLEY SCREW	29	5	19-34488	PLUG, EXPANSION-CAMSHAFT BEARING HOLE	31	4
13-39131	LOCKWASHER, HARMONIC BALANCER BOLT	33	47	19-37531	PLUG, OIL CHANNEL-CYLINDER BLOCK	31	3
14-48467	TAB WASHER, ADJUSTER TRUNNION SCREW	27	23	22-28624	TEE, FITTING - FUEL PUMP	11	7
16-33213	CARBURETOR ASSEMBLY SEE A12 FOR	13	47	22-29085	FITTING, OIL PRESSURE SENDER ADAPTOR	3	21
16-33213	STUD, FLAME ARRESTOR MOUNTING - CARBURETOR	13	48				

PARTS INDEX

Part Number	Description	Pg.	Ref. No.	Part Number	Description	Pg.	Ref. No.
22-32802	PLUG, PIPE - EXHAUST MANIFOLD (1/8-27)	21	4	23-52261	BEARING UNIT, CRANKSHAFT MAIN-REAR (STANDARD)	31	13
22-32802	PLUG, PIPE-EXHAUST ELBOW	21	20	23-52262	BEARING UNIT, CRANKSHAFT MAIN-REAR (.001 U.S.)	31	13
22-32974	ADAPTOR, OIL PRESSURE SENDER TO CYLINDER BLOCK	3	20	23-52263	BEARING UNIT, CRANKSHAFT MAIN-REAR (.002 U.S.)	31	13
22-36382	PLUG, WATER DRAIN- CYLINDER BLOCK	31	6	23-52264	BEARING UNIT, CRANKSHAFT MAIN-REAR (.010 U.S.)	31	13
22-45122	CHECK VALVE, FUEL LINE .	11	8	23-52265	BEARING UNIT, CRANKSHAFT MAIN-REAR (.020 U.S.)	31	13
22-46131	CONNECTOR, VENT HOSE TO CONNECTOR	35	13	23-52270	BEARING (PAIR), CONNECTING ROD (STANDARD)	31	26
22-48118	PLUG, EXHAUST ELBOW . .	21	19	23-52271	BEARING (PAIR), CONNECTING ROD (.001 U.S.)	31	26
22-48118	PLUG, EXHAUST MANIFOLD	21	3	23-52272	BEARING (PAIR), CONNECTING ROD (.002 U.S.)	33	26
22-48336	PLUG, CYLINDER HEAD . . .	35	29	23-52273	BEARING (PAIR), CONNECTING ROD (.010 U.S.)	33	26
22-48439	ADAPTOR, OUTLET ELBOW TO FUEL LINES	11	12	23-52274	BEARING (PAIR), CONNECTING ROD (.020 U.S.)	33	26
22-49210A1	TEE ASSEMBLY, FUEL LINE	11	10	23-52482	BEARING UNIT, CAMSHAFT (FRONT AND REAR)	31	10
22-49217	FITTING, FUEL LINE TEE . .	11	11	23-52483	BEARING UNIT, CAMSHAFT (INTERMEDIATE)	31	11
22-49676	ELBOW, FUEL PUMP TO FUEL LINE (OUTLET)	11	11	24-33050	SPRING, IDLE NEEDLE	19	54
22-52089	ELBOW, WATER DISTRIBUTION BLOCK . . .	21	32	24-34373	SPRING, IDLE STOP SCREW	19	44
22-52669	CONNECTOR, VENT- ROCKER COVER	35	12	24-35214	SPRING, VALVE	35	25
23-33186	BUSHING, WATER PUMP BRACKET SCREW	29	37	24-48141	SPRING, POWER PISTON . .	17	40
23-33186	SPACER, ALTERNATOR SCREW	5	19	24-48142	SPRING, METERING ROD - PRIMARY	17	36
23-34469	BEARING, CAMSHAFT THRUST	33	38	24-52082	SPRING, THROTTLE RETURN	13	37
23-35168	BEARING, DISTRIBUTOR PILOT SHAFT	31	7	24-52280	SPRING, BREAKER CAM ADVANCE WEIGHT	7	8
23-47511	SLEEVE, WATER PUMP COVER	29	17	24-52727	SPRING, FILTER NUT	19	45
23-52095	SPACER, MOUNTING BRACKET TO EXHAUST MANIFOLD (5/16")	11	29	24-52728	SPRING, CHOKE RETURN .	15	67
23-52096	SPACER, MOUNTING BRACKET TO EXHAUST MANIFOLD (3/4")	11	27	24-54217	SPRING, THROTTLE RETURN	13	37
23-52097	SLEEVE, EXHAUST MANIFOLD SCREW	21	6	25-33666	GROMMET, MOUNTING PLATE - PRIMARY WIRE .	7	17
23-52133	HOSE, WATER PUMP TO THERMOSTAT HOUSING	29	20	26-34217	SEAL, VALVE SPRING CAP .	35	23
23-52256	BEARING UNIT, CRANKSHAFT MAIN (STANDARD)	31	12	26-47401	SEAL, MECHANICAL-SHAFT AND BEARING	29	9
23-52257	BEARING UNIT, CRANKSHAFT MAIN (.001 U.S.)	31	12	26-47531	SEAL, FLOATING-SHAFT AND BEARING	29	10
23-52258	BEARING UNIT, CRANKSHAFT MAIN (.002 U.S.)	31	12	26-49947	OIL SEAL UNIT, CRANKSHAFT REAR BEARING	31	17
23-52259	BEARING UNIT, CRANKSHAFT MAIN (.010 U.S.)	31	12	26-49952	OIL SEAL, CRANKCASE COVER	37	39
23-52260	BEARING UNIT, CRANKSHAFT MAIN (.020 U.S.)	31	12				

PARTS INDEX

Part Number	Description	Pg.	Ref. No.	Part Number	Description	Pg.	Ref. No.
27-33600	GASKET, EXHAUST HOSE			32-52481	HOSE, WATER		
	FLANGE	39	4		DISTRIBUTION BLOCK TO		
27-33680	GASKET, WATER				END CAP/CONNECTOR . .	21	29
	DISTRIBUTION BLOCK . .	21	34	32-53391	TUBE, OIL LEVEL GUAGE . .	37	57
27-34213	GASKET, FUEL PUMP	11	4	33-54527	SPARK PLUG (AC#CR-44N)	7	31
27-34460	GASKET, OIL PUMP COVER	37	48	35-49088	FILTER, FUEL - FUEL PUMP	11	2
27-34486	GASKET, DISTRIBUTOR . . .	7	25	35-53336	FILTER, FUEL -		
27-46041	GASKET, EXHAUST				CARBURETOR INLET . . .	19	46
	MANIFOLD TO CYLINDER			37-32852	DECAL, ROCKER COVER . .	35	2
	HEAD	21	16	37-52467	DECAL, ROCKER COVER-		
27-47410	GASKET, WATER PUMP				"200 H.P."	35	15
	COVER TO WATER PUMP			38-31042	SERIAL PLATE	25	20
	BODY	29	18	39-52266	RING, PISTON-6 SETS		
27-47453	GASKET, CYLINDER HEAD .	35	31		(STANDARD)	31	9
27-47590	GASKET, THERMOSTAT			39-52267	RING, PISTON-6 SETS (.020		
	COVER	21	36		O.S.)	31	9
27-48043	GASKET, END CAP TO			39-52268	RING, PISTON-6 SETS (.030		
	EXHAUST MANIFOLD . . .	21	14		O.S.)	31	9
27-48043	GASKET, END			43-33664	GEAR, DRIVE - MAIN SHAFT	7	3
	CAP/CONNECTOR TO			43-46743	GEAR, CRANKSHAFT	33	44
	EXHAUST MANIFOLD . . .	21	25	43-46745	GEAR, TIMING-CAMSHAFT .	33	39
27-49936	GASKET, ROCKER COVER .	35	16	46-47506A1	WATER PUMP ASSEMBLY,		
27-49949	GASKET SET, OIL PAN	37	43		COMPLETE	29	1
27-49953	GASKET, CRANKCASE			46-47506A2	BODY ASSEMBLY, WATER		
	COVER	37	40		PUMP	29	11
27-49955	GASKET, OIL PAN DRAIN			47-47519	IMPELLER	29	14
	SCREW	37	47	50-45120	STARTER MOTOR	5	1
27-52076	GASKET, EXHAUST ELBOW			53-47657	RING, RETAINING - SGAFT		
	TO EXHAUST MANIFLOD	21	21		AND BEARING	29	7
27-52248	GASKET, WATER PUMP . . .	33	30	54-22627	CLIP, WIRING HARNESS TO		
27-52255	GASKET, CRANKCASE AND				BOAT	3	5
	PUSH ROD COVER	37	55	54-22740	CLAMP, WIRING HARNESS		
27-52457	GASKET, CARBURETOR . . .	13	56		TO EXHAUST MANIFOLD		
28-34466	KEY, CAMSHAFT TIMING				(3/8")	21	9
	GEAR	33	37	54-24836	CLAMP, WIRING HARNESS		
28-34466	KEY, PULLEY AND GEAR				TO MANIFOLD	3	8
	LOCATING	33	43	54-24871	CLAMP, WIRING HARNESS		
28-34514	KEY, VALVE STEM (2 PER				TO HOUSING	25	11
	VALVE)	35	21	54-28938	CLAMP, FUEL LINE		
32-30466	FUEL LINE, FUEL TANK TO				ATTACHING	11	18
	FUEL PUMP	11	6	54-28938	CLAMP, FUEL LINE TO		
32-45121	FUEL LINE, RETURN - FUEL				CYLINDER BLOCK	11	14
	PUMP	11	9	54-32780	CLAMP, HOSE TO WATER		
32-46471	NOZZLE, OIL-TIMING GEAR	33	36		PUMP AND THERMOSTAT		
32-46751A1	HOSE ASSEMBLY, VENT -				HOUSING	29	21
	FLAME ARRESTOR TO			54-32781	CLAMP, HOSE T WATER		
	ROCKER COVER	13	61		DISTRIBUTION BLOCK		
32-47996	HOSE, VENT - FLAME				AND WATER PUMP	23	40
	ARRESTOR TO ROCKER			54-32880	CLAMP, HOSE TO WATER		
	COVER (9 3/4")	13	61		DISTRIBUTION BLOCK		
32-48659--1	HOSE, EXHAUST (4")	39	9		AND END CAP		
32-48659--2	HOSE, EXHAUST (5 1/4") . .	39	11	54-33361	CONNECTO	21	30
32-49705	TUBE, WATER				CLIP, WIRING HARNESS		
	SEPARATION-EXHAUST				RETAINER	21	27
	ELBOW	21	18	54-33361	CLIP, WIRING HARNESS-		
32-52099	HOSE, WATER				ROCKER COVER SCREW	35	11
	DISTRIBUTION BLOCK TO			54-33683	CLAMP, COVER TO FLANGE	39	2
	WATER PUMP	21	39	54-33683	CLAMP, EXHAUST HOSE		
32-52461	FUEL LINE, FUEL PUMP TO				ATTACHING	39	8
	CARBURETOR (42")	11	13				

PARTS INDEX

Part Number	Description	Pg.	Ref. No.	Part Number	Description	Pg.	Ref. No.
54-35861	CLIP,ROCKER COVER			1397-3325	FLOAT BOWL ASSEMBLY . .	19	42
	CHIMNEY STUD	35	7	1397-3326	RETAINER, PUMP		
54-38426	CLAMP, WATER PUMP				DISCHARGE BALL	17	38
	COVER TO WATER PUMP	23	42	1397-3327	FLOAT ASSEMBLY	17	22
54-46997	CLAMP, WIRING HARNESS			1397-3328	POWER PISTON ASSEMBLY	17	35
	TO HOUSING	25	11	1397-3329	RETAINER, POWER PISTON	17	37
54-47528	CLAMP, ADJUSTING			1397-3330	NUT, FILTER - FUEL INLET .	19	47
	TRUNNION SCREW	27	14	1397-3331	INSERT, FLOAT BOWL	19	41
54-47715	CLIP, HOSE TO EXHAUST			1397-3333	ROD, PUMP	19	50
	MANIFOLD	29	22	1397-3334	THROTTLE BODY		
54-53101	CLAMP, VENT HOSE TO				ASSEMBLY	19	52
	FITTING	13	61	1397-3335	LEVER, CAM	19	56
57-32850	BELT, ALTERNATOR,			1397-3336	LEVER, FAST IDLE	19	57
	WATER PUMP PULLEY			1397-3337	AIR HORN ASSEMBLY	17	1
	AND CRAKSHAFT PULLEY	33	41	1397-3338	METERING ROD,		
57-45367	BELT, WATER PUMP	29	39		SECONDARY	17	5
222-3657	FLYWHEEL, CRANKSHAFT .	31	18	1397-3339	BRACKET ASSEMBLY,		
393-1275	SLEEVE, TERMINAL END				VACUUM CONTROL	17	31
	COVER	7	30	1397-3340	CONTROL ASSEMBLY,		
393-1286	BALLAST	9	45		VACUUM	17	33
425-3656	CRANKSHAFT	33	42	1397-3341	BAFFLE, FLOAT BOWL	17	25
430-3663	CAMSHAFT	33	27	1397-3631	VALVE, CHOKE - CHOKE		
613-3662	CONNECTING ROD				SHAFT	17	20
	ASSEMBLING	31	23				
734-3659	PISTON AND PISTON PIN						
	ASSEMBLY (.001 O.S.) . . .	31	8				
734-3660	PISTON AND PISTON PIN						
	ASSEMBLY (.020 O.S.) . . .	31	8				
734-3661	PISTON AND PISTON PIN						
	ASSEMBLY (.030 O.S.) . . .	31	8				
840-3658	CYLINDER BLOCK						
	ASSEMBLY	31	1				
840-3658	CYLINDER BLOCK						
	ASSEMBLY	35	35				
937-3040	CYLLINDER HEAD						
	ASSEMBLY	35	26				
1347-3237A2	CARBURETOR ASSEMBLY						
	SEE A12 FOR	13	47				
1347-3237A2	CARBURETOR ASSEMBLY,						
	COMPLETE	17	-				
1347-3237A4	CARBURETOR ASSEMBLY,						
	COMPLETE	17	-				
1397-3307A1	OVERHAUL KIT	19	-				
1397-3308	OFF ENGINE KIT	19	-				
1397-3309	GASKET SET	19	-				
1397-3311	LEVER, ACTUATING - PUMP	17	9				
1397-3313	HOLDER KIT, SECONDARY						
	METERING ROD	17	4				
1397-3314	LEVER, AIR VALVE						
	LOCKOUT	17	2				
1397-3315	SPRING AND CAM KIT, AIR						
	VALVE	19	-				
1397-3318	ROD, VACUUM CONTROL .	17	29				
1397-3319	CAM, FAST IDLE	17	28				
1397-3320	HOSE, VACUUM	17	34				
1397-3321	CHOKE SHAFT AND LEVER						
	ASSEMBLY	17	19				
1397-3323	LEVER, INTERMEDIATE						
	CHOKE	17	24				
1397-3324	ROD, CHOKE	17	26				